

## LOCALITY MAP

NOT TO SCALE  
MELBAY'S REF: 127 G4

- SITE ESTABLISHMENT**
1. PLASTIC OR STEEL MESH FENCING (BARRIER MESH) MUST BE USED TO PROTECT WORKSITE AND ALL APPROPRIATE SIGNS TO THE SATISFACTION OF THE SUPERVISING ENGINEER.
  2. THE CONTRACTOR IS TO NOTIFY ALL RESIDENTS BY LETTER REGARDING ACCESS RESTRICTIONS TO THEIR PROPERTIES (AT LEAST 24HRS IN ADVANCE).
  3. IT IS THE CONTRACTORS RESPONSIBILITY TO TRANSFER ANY TBM'S THAT MAY BE AFFECTED BY THE WORKS PRIOR TO THEIR REMOVAL.
  4. SETOUT DIMENSIONING AND RADII ARE FROM CENTRELINE OF ROAD UNLESS OTHERWISE SHOWN.

## EARTHWORKS

1. THE CONTRACTOR IS TO VERIFY ALL LEVELS WITH THE SUPERVISING ENGINEER PRIOR TO COMMENCING ANY PAVEMENT WORKS.
2. ALL DISTURBED AREAS OUTSIDE THE WORKS ARE TO BE REINSTATED TO THE SATISFACTION OF COUNCIL.
3. REMOVAL OF VEGETATION OR TRIMMING OF TREES IS TO BE DONE UNDER COUNCIL DIRECTION.
4. NO TREE ROOTS GREATER THAN 40mm ARE TO BE CUT BY THE CONTRACTOR. THE CONTRACTOR IS TO OBTAIN APPROVAL FROM THE SUPERVISING ENGINEER TO REMOVE TREE ROOTS GREATER THAN 40mm.
5. THE CONTRACTOR SHALL NOT CAUSE ANY DAMAGE TO TREE BRANCHES OR TREE TRUNKS.
6. BACKFILL ALL TRENCHES BENEATH ROAD PAVEMENT AND VEHICLE CROSSINGS WITH CLASS 2 F.C.C.

## DRAINAGE

1. ALL DRAINAGE WORKS TO BE TO AS3500.
2. STORM WATER PIPES TO BE LAID WITH MINIMUM COVER OF 600mm UNLESS OTHERWISE SPECIFIED ON PLANS. REFER TO DRAINAGE PIPE LEVELS GIVEN IN DESIGN DOCUMENTATION WHERE PROVIDED.
3. ALL DRAINAGE PIPES TO BE LAID TRUE TO LINE AND GRADE ON MIN 100mm OF 20mm CLASS 2 CRUSHED CONCRETE BEDDING.
4. ALL REINFORCED CONCRETE DRAINAGE PIPES TO BE RUBBER RING JOINTED AND CLASS 2, UNLESS SPECIFIED OTHERWISE.
5. ALL UPVC PIPES SHALL BE SEWER CLASS SN8 EXTRA HEAVY DUTY, SOLVENT WELDED UNLESS SPECIFIED OTHERWISE.
6. ALL PITS 1.0m DEPTH AND OVER TO BE FITTED WITH STEP IRONS.
7. ALL PITS TO HAVE FORMED BASES TO ALLOW SMOOTH FLOWS THROUGH PITS.
8. ALL DRAINAGE TRENCHES IN ROADWAY TO BE BACKFILLED WITH 20mm CLASS 2 CRUSHED CONCRETE TO THE UNDERSIDE OF PROPOSED PAVEMENT DETAIL.
9. SUBSURFACE DRAINAGE TO BE LAID BEHIND KERB (OR UNDER KERB BASE WHERE INSUFFICIENT SPACE IS AVAILABLE) IN ACCORDANCE WITH ENGINEERING DESIGN & CONSTRUCTION MANUAL STANDARD DRAWING EDCM 202.
10. SUBSURFACE DRAINAGE TO BE APPROVED 1000 CLASS SN8 SLOTTED/PERFORATED PIPE WITH GEOTEXTILE SOCK SURROUND & TO BE LAID IN ACCORDANCE WITH ENGINEERING DESIGN & CONSTRUCTION MANUAL STANDARD DRAWING EDCM 202, LAID AT A MINIMUM GRADE OF 1 in 100.

## SERVICING

1. THE LOCATION OF ALL EXISTING SERVICES IS BASED ON INFORMATION SUPPLIED BY THE RELEVANT AUTHORITIES AND IS APPROXIMATE ONLY. THE CONTRACTOR SHALL DETERMINE THE LOCATION OF ALL SERVICES BEFORE COMMENCING WORKS AND PROTECT THE SAME FOR THE DURATION OF THE WORKS.
2. BACKFILL ALL TRENCHES BENEATH ROAD PAVEMENT AND VEHICLE CROSSINGS WITH CLASS 2 CRUSHED CONCRETE
3. "NO GO ZONES" TO BE ADHERED TO FOR ALL EXISTING SERVICES WHEN WORKING AROUND OR UNDER THEM. IT IS THE CONTRACTOR'S RESPONSIBILITY TO CONTACT THE RELEVANT SERVICE PROVIDER AS TO CLEARANCES.

## MISCELLANEOUS

1. THE LOCATION OF ALL EXISTING SIGNS ARE TO BE RECORDED PRIOR TO THE COMMENCEMENT OF WORKS AND ANY REMOVED TO MAKE WAY FOR THE WORKS ARE TO BE REINSTATED TO ORIGINAL POSITION OR TO A LOCATION AS DIRECTED BY SUPERVISING ENGINEER.
2. ALL LINE MARKING IS TO BE REINSTATED IN ORIGINAL POSITION WHERE DISTURBED OR REMOVED BY CONCRETE PAVEMENT AND OR ASPHALT REPLACEMENT UNLESS OTHERWISE SHOWN.
3. ALL EXISTING HOUSE DRAINS SHALL BE RECONNECTED TO THE UNDERGROUND DRAINAGE SYSTEM UNLESS SHOWN OTHERWISE OR DIRECTED BY THE SUPERVISING ENGINEER IN ACCORDANCE WITH STANDARD - S121 AT A MINIMUM GRADE OF 1:100. INSPECTION OPENING TO BE PLACED OUTSIDE CONCRETE PATH UNLESS OTHERWISE SPECIFIED. NOT ALL HOUSE WATER DRAINS MAY BE SHOWN, CONTRACTOR TO CHECK DURING CONSTRUCTION AND CONNECT IN ACCORDANCE TO COUNCIL REQUIREMENTS.

01	FUNCTIONAL DESIGN - ISSUED FOR REVIEW	04-05-2021
00	FUNCTIONAL DESIGN - ISSUED FOR REVIEW	30-09-2020
VER	DESCRIPTION	DATE

CONSULTANT ENGINEER

**PROCIVIL**  
CONSULTING ENGINEERING

*Specialist Civil Engineering Design Consultants*

Commitment | Communication | Collaboration

PROCIVIL CONSULTING PTY LTD  
ABN 51 759 386 082  
SUITE 9, 12 MAROONDAH HWY, RINGWOOD VIC 31134  
PO BOX 164, RINGWOOD VIC 31134  
P: (03) 8644 6834  
E: info@procivil.com.au  
www.procivil.com.au

CIVIL ENGINEERING DESIGN  
DEAN DIMITROS

TECHNICAL PEER REVIEW  
CHRIS PROCTOR

REGISTERED & CHARTERED PROFESSIONAL ENGINEER'S REVIEW  
CHRIS PROCTOR

ORIENTATION

OR AS SHOWN

ORIGINAL SCALE & SHEET SIZE  
AS SHOWN @ A1

HEIGHT DATUM  
AHD

COORDINATE DATUM  
MGA 94 ZONE 55

SURVEY DATE  
29-05-2020

AERIAL IMAGE DATE  
18-12-2019

LOCAL GOVERNMENT AREA  
**SHIRE OF CARDINIA**

CLIENT

**Cardinia**

CLIENT PROJECT MANAGER / CONTACT  
DANIEL POTTER | CARDINIA SHIRE COUNCIL

**FUNCTIONAL DESIGN**

**ROAD & DRAINAGE RECONSTRUCTION WORKS**

**CRICHTON ROAD AND PRINCESS AVENUE, EMERALD**

TITLE SHEET - NOTES, LOCALITY PLAN, DRAWING INDEX & DETAILS

PROJECT No.  
PC18089

SHEET No.  
01 OF 10

VERSION  
01

DWG No.  
PC18089 - 01 - 01

# ROAD & DRAINAGE RECONSTRUCTION WORKS

## PRINCESS AVENUE AND CRICHTON ROAD, EMERALD



**WARNING**  
BEWARE OF UNDERGROUND SERVICES.  
THE LOCATION OF EXISTING UNDERGROUND SERVICES ARE APPROXIMATE ONLY AND THEIR EXACT POSITION SHOULD BE PROVEN ON SITE. NO GUARANTEE IS GIVEN THAT ALL EXISTING SERVICES ARE SHOWN.

## DRAWING INDEX

SHEET No.	TITLE
1	TITLE SHEET - NOTES, LOCALITY PLAN, DRAWING INDEX & DETAILS
2	OVERALL PLAN
3	SECTIONS A-A, B-B & C-C
4	GENERAL LAYOUT PLAN
5	GENERAL LAYOUT PLAN
6	GENERAL LAYOUT PLAN
7	GENERAL LAYOUT PLAN
8	GENERAL LAYOUT PLAN
9	DRAINAGE CATCHMENT ANALYSIS PLAN
10	DRAINAGE MANAGEMENT PLAN

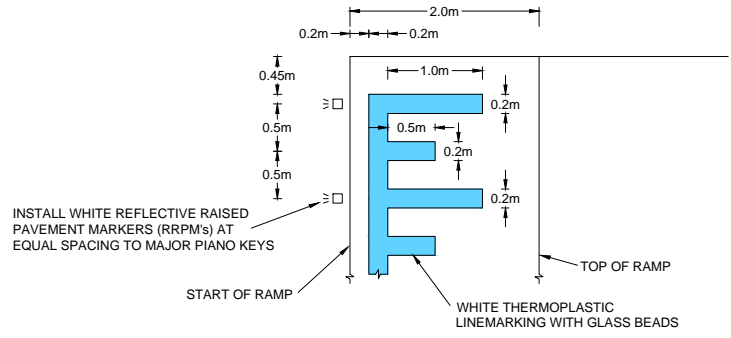

## RAISED PAVEMENT LINEMARKING DETAIL

NOT TO SCALE

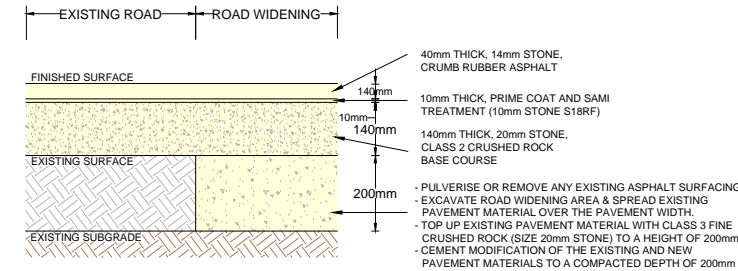

## PAVEMENT DETAIL

IN ACCORDANCE WITH GEOTECHNICAL REPORT BY  
SITE GEOTECHNICAL PTY LTD REF: R8377-1 SECTION 7.4.2 OPTION 2 (01 FEB 2021)

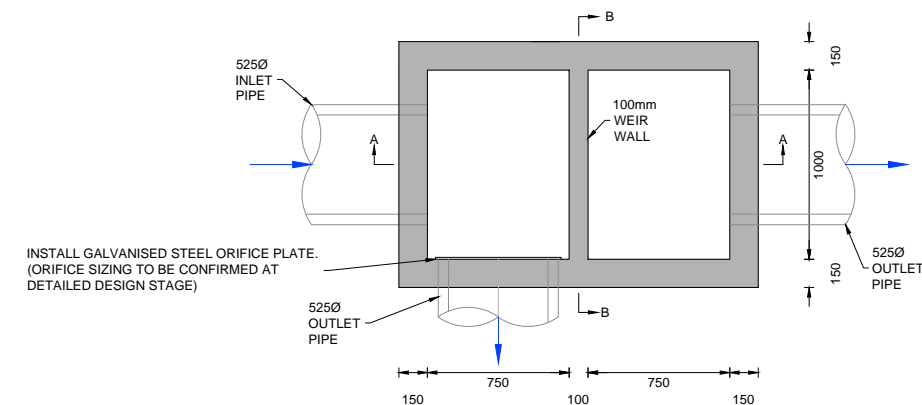

## PLAN VIEW

1:20 SCALE @ A4

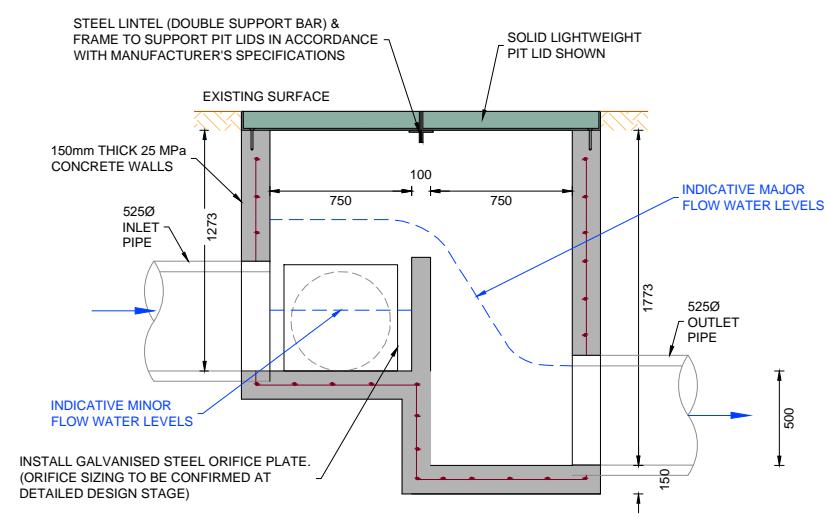

## SECTION A-A

1:20 SCALE @ A4

## WEIR PIT DETAIL

NOT TO SCALE

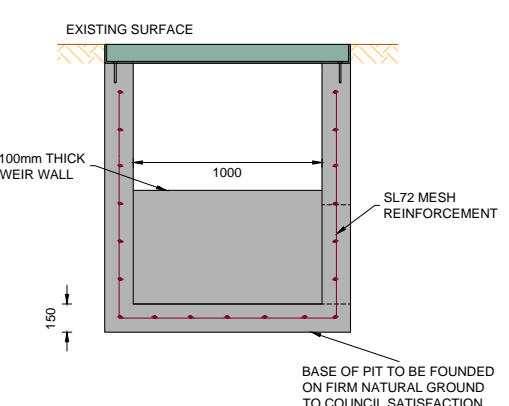

## SECTION B-B

1:20 SCALE @ A4

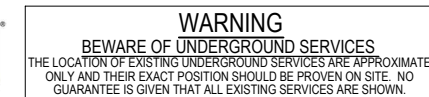
[illegible]



**WARNING**  
BEWARE OF UNDERGROUND SERVICES  
THE LOCATION OF EXISTING UNDERGROUND SERVICES ARE APPROXIMATE ONLY AND THEIR EXACT POSITION SHOULD BE PROVEN ON SITE. NO GUARANTEE IS GIVEN THAT ALL EXISTING SERVICES ARE SHOWN.

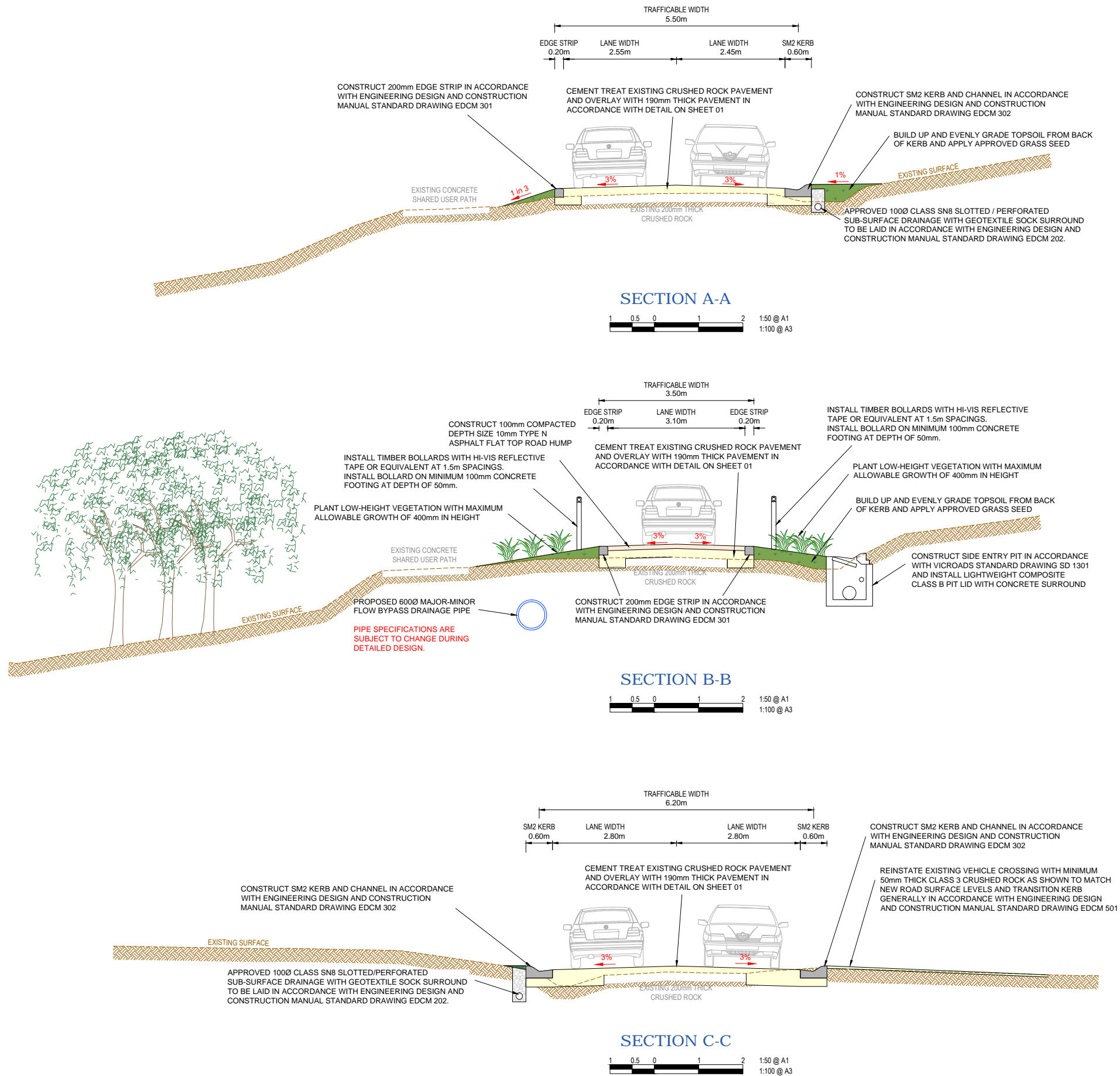

01	FUNCTIONAL DESIGN - ISSUED FOR REVIEW	04-05-2021
00	FUNCTIONAL DESIGN - ISSUED FOR REVIEW	30-09-2020
VER	DESCRIPTION	DATE

CONSULTANT ENGINEER

**PROCIVIL**  
CONSULTING ENGINEERING

Specialist Civil Engineering Design Consultants

Commitment | Communication | Collaboration

PROCIVIL CONSULTING PTY LTD  
ABN 51 759 386 092  
SUITE 9, 12 MAROONDAH HWY, RINGWOOD VIC 31134  
PO BOX 164, RINGWOOD VIC 31134  
P: (03) 8644 6834  
E: info@procivil.com.au  
www.procivil.com.au

CIVIL ENGINEERING DESIGN  
DEAN DIMITROS

TECHNICAL PEER REVIEW  
CHRIS PROCTOR

REGISTERED & CHARTERED PROFESSIONAL ENGINEER'S REVIEW  
CHRIS PROCTOR

ORIENTATION

OR AS SHOWN

ORIGINAL SCALE & SHEET SIZE  
AS SHOWN @ A1

HEIGHT DATUM  
AHD

COORDINATE DATUM  
MGA 94 ZONE 55

SURVEY DATE  
29-05-2020

AERIAL IMAGE DATE  
18-12-2019

LOCAL GOVERNMENT AREA  
**SHIRE OF CARDINIA**

CLIENT

CLIENT PROJECT MANAGER / CONTACT  
DANIEL POTTER | CARDINIA SHIRE COUNCIL

**FUNCTIONAL DESIGN**

**ROAD & DRAINAGE RECONSTRUCTION WORKS**

CRICHTON ROAD AND PRINCESS AVENUE, EMERALD

SECTIONS A-A, B-B & C-C

PROJECT No.  
**PC18089**

SHEET No.  
**03 OF 10**

VERSION  
**01**

DWG No.  
PC18089 - 03 - 01

## LEGEND

- FULL DEPTH PAVEMENT ROAD WIDENING IN ACCORDANCE WITH DETAILS ON SHEET 01
- EXISTING CRUSHED ROCK PAVEMENT OVERLAY IN ACCORDANCE WITH DETAILS ON SHEET 01
- 50mm THICK CLASS 3 CRUSHED ROCK
- ASPHALT VEHICLE CROSSING TO BE CONSTRUCTED IN ACCORDANCE WITH ENGINEERING DESIGN & CONSTRUCTION MANUAL STANDARD DRAWING EDCM 501
- 100mm DEPTH TYPE N SIZE 10mm ASPHALT RAISED PAVEMENT
- CONCRETE VEHICLE CROSSING TO BE CONSTRUCTED IN ACCORDANCE WITH ENGINEERING DESIGN & CONSTRUCTION MANUAL STANDARD DRAWING EDCM 501

- CONCRETE KERB AND CHANNEL IN ACCORDANCE WITH ENGINEERING DESIGN & CONSTRUCTION MANUAL STANDARD DRAWING EDCM 301
- EXISTING DRAINAGE PIPE
- REMOVE/DECOMMISSION EXISTING DRAINAGE PIPE
- NEW DRAINAGE PIT AND PIPE
- TABLE DRAIN INVERT
- DIRECTION OF CHANNEL FLOW
- SHEET FLOW RUNOFF
- PAVEMENT LINE MARKING
- TWO-WAY RAISED REFLECTIVE PAVEMENT MARKERS (RRPMs) TO BE INSTALLED AS SHOWN IN ACCORDANCE WITH VICROADS TRAFFIC ENGINEERING MANUAL VOL 2 CH 19
- PROPOSED PAVEMENT GRADE

- EX W EXISTING WATER
- EX G EXISTING GAS
- EX S EXISTING SEWER
- EX T EXISTING TELECOMMUNICATIONS
- EX E EXISTING UNDERGROUND ELECTRICITY
- E OH EXISTING UNDERGROUND ELECTRICITY
- EXISTING CONTOUR MAJOR (1.0m)
- EXISTING CONTOUR MINOR (0.20m)
- FILL BATTER EXTENT
- CUT BATTER EXTENT
- TREE TO BE REMOVED
- TREE NUMBER
- BUILD UP AND EVENLY GRADE TOPSOIL FROM BACK OF KERB AND APPLY APPROVED GRASS SEED



**WARNING**  
BEWARE OF UNDERGROUND SERVICES.  
THE LOCATION OF EXISTING UNDERGROUND SERVICES ARE APPROXIMATE ONLY AND THEIR EXACT POSITION SHOULD BE PROVEN ON SITE. NO GUARANTEE IS GIVEN THAT ALL EXISTING SERVICES ARE SHOWN.

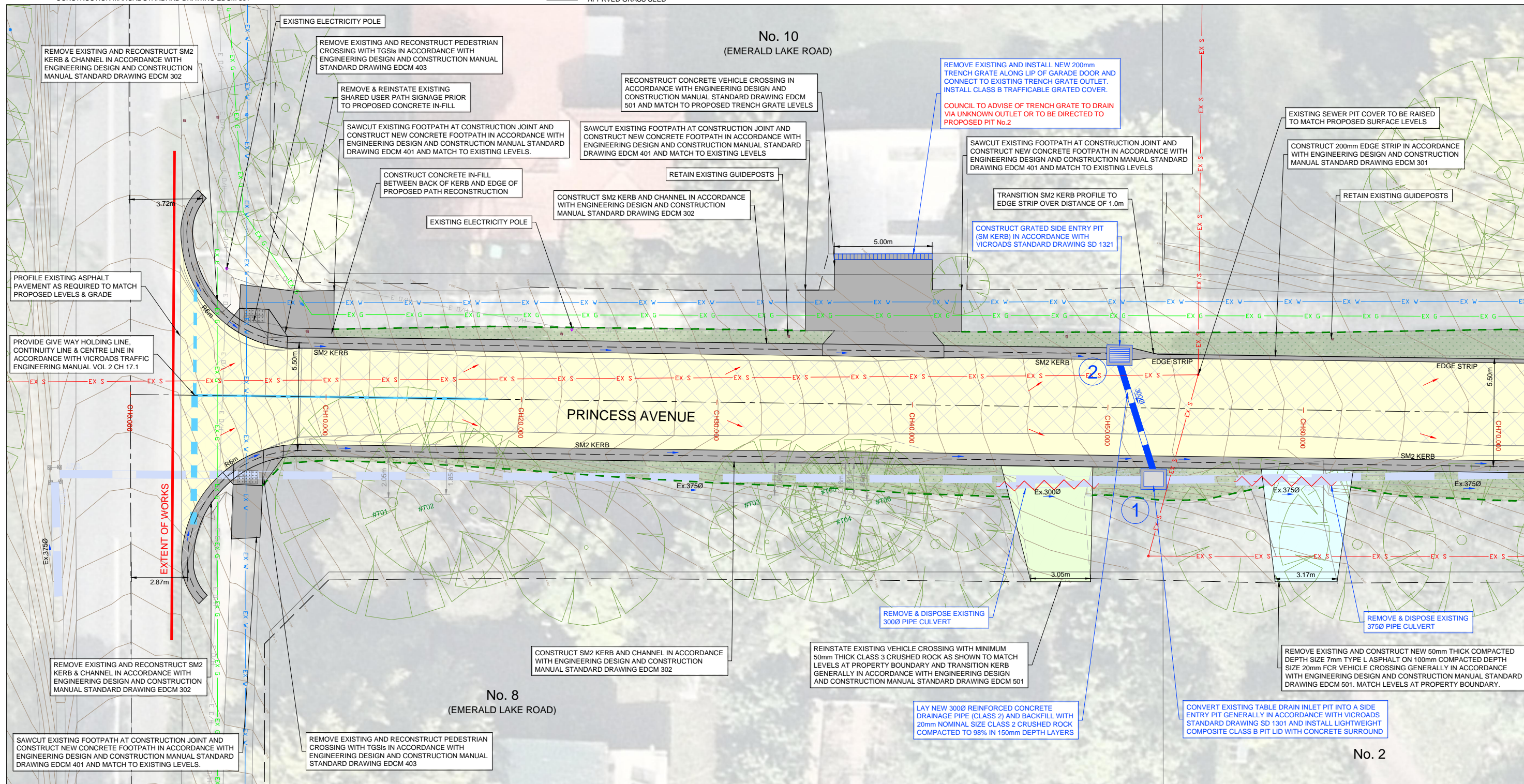

## GENERAL LAYOUT PLAN

2 1 0 2 4 1:100 @ A1  
1:200 @ A3



ORIGINAL SCALE & SHEET SIZE  
AS SHOWN @ A1  
HEIGHT DATUM  
AHD  
COORDINATE DATUM  
MGA 94 ZONE 55  
SURVEY DATE  
29-05-2020  
AERIAL IMAGE DATE  
18-12-2019

LOCAL GOVERNMENT AREA  
**SHIRE OF CARDINIA**  
CLIENT  
  
CLIENT PROJECT MANAGER / CONTACT  
DANIEL POTTER | CARDINIA SHIRE COUNCIL

**FUNCTIONAL DESIGN**  
**ROAD & DRAINAGE RECONSTRUCTION WORKS**  
CRICHTON ROAD AND PRINCESS AVENUE, EMERALD

GENERAL LAYOUT PLAN

PROJECT No.  
PC18089  
SHEET No.  
04 OF 10  
VERSION  
01  
DWG No.  
PC18089 - 04 - 01

01	FUNCTIONAL DESIGN - ISSUED FOR REVIEW	04-05-2021
00	FUNCTIONAL DESIGN - ISSUED FOR REVIEW	30-09-2020
VER	DESCRIPTION	DATE

CONSULTANT ENGINEER

**PROCIVIL**  
CONSULTING ENGINEERING  
Specialist Civil Engineering Design Consultants  
Commitment | Communication | Collaboration

PROCIVIL CONSULTING PTY LTD  
ABN 51 759 386 092  
SUITE 9, 12 MAROONDAH HWY, RINGWOOD VIC 3134  
PO BOX 164, RINGWOOD VIC 3134  
P: (03) 8644 6834  
E: info@procivil.com.au  
www.procivil.com.au

CIVIL ENGINEERING DESIGN  
DEAN DIMITROS  
REGISTERED & CHARTERED PROFESSIONAL ENGINEER'S REVIEW  
CHRIS PROCTOR

TECHNICAL PEER REVIEW  
CHRIS PROCTOR

CONTINUED ON SHEET 05

## LEGEND

- FULL DEPTH PAVEMENT ROAD WIDENING IN ACCORDANCE WITH DETAILS ON SHEET 01
- EXISTING CRUSHED ROCK PAVEMENT OVERLAY IN ACCORDANCE WITH DETAILS ON SHEET 01
- 50mm THICK CLASS 3 CRUSHED ROCK
- ASPHALT VEHICLE CROSSING TO BE CONSTRUCTED IN ACCORDANCE WITH ENGINEERING DESIGN & CONSTRUCTION MANUAL STANDARD DRAWING EDCM 501
- 100mm DEPTH TYPE N SIZE 10mm ASPHALT RAISED PAVEMENT
- CONCRETE VEHICLE CROSSING TO BE CONSTRUCTED IN ACCORDANCE WITH ENGINEERING DESIGN & CONSTRUCTION MANUAL STANDARD DRAWING EDCM 501

- CONCRETE KERB AND CHANNEL IN ACCORDANCE WITH ENGINEERING DESIGN & CONSTRUCTION MANUAL STANDARD DRAWING EDCM 301
- EXISTING DRAINAGE PIPE
- REMOVE/DECOMMISSION EXISTING DRAINAGE PIPE
- NEW DRAINAGE PIT AND PIPE
- TABLE DRAIN INVERT
- DIRECTION OF CHANNEL FLOW
- SHEET FLOW RUNOFF
- PAVEMENT LINE MARKING
- TWO-WAY RAISED REFLECTIVE PAVEMENT MARKERS (RRPMs) TO BE INSTALLED AS SHOWN IN ACCORDANCE WITH VICROADS TRAFFIC ENGINEERING MANUAL VOL 2 CH 19
- PROPOSED PAVEMENT GRADE

- EXISTING WATER
- EXISTING GAS
- EXISTING SEWER
- EXISTING TELECOMMUNICATIONS
- EXISTING UNDERGROUND ELECTRICITY
- EXISTING UNDERGROUND ELECTRICITY
- EXISTING CONTOUR MAJOR (1.0m)
- EXISTING CONTOUR MINOR (0.20m)
- FILL BATTER EXTENT
- CUT BATTER EXTENT
- TREE TO BE REMOVED
- TREE NUMBER
- BUILD UP AND EVENLY GRADE TOPSOIL FROM BACK OF KERB AND APPLY APPROVED GRASS SEED

## SIGN LEGEND

- HUMP WARNING W5-10A
- ADVISORY SPEED W8-2
- SIGNS SHOWN AS



**WARNING**  
BEWARE OF UNDERGROUND SERVICES.  
THE LOCATION OF EXISTING UNDERGROUND SERVICES ARE APPROXIMATE ONLY AND THEIR EXACT POSITION SHOULD BE PROVEN ON SITE. NO GUARANTEE IS GIVEN THAT ALL EXISTING SERVICES ARE SHOWN.

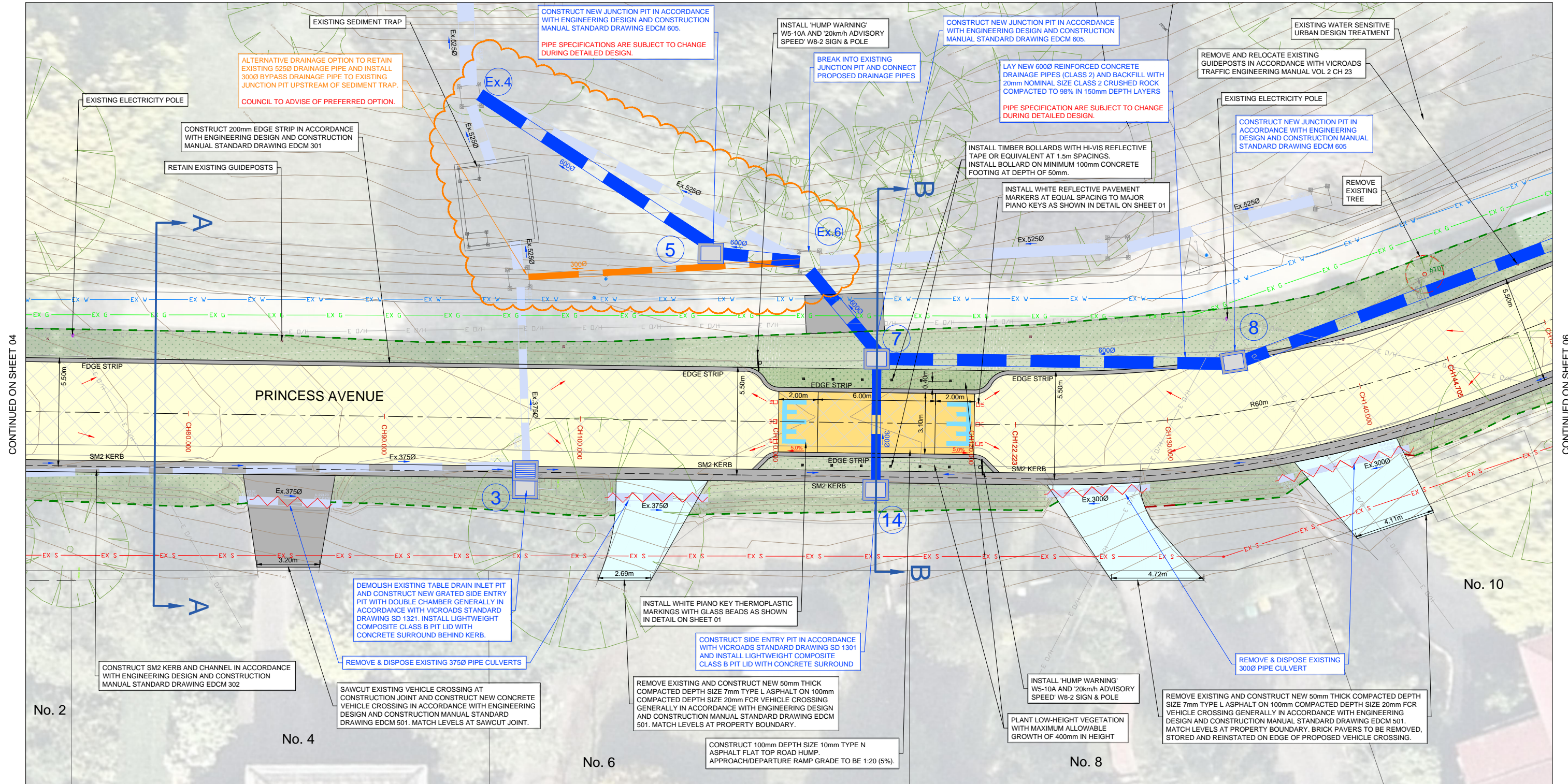

## GENERAL LAYOUT PLAN

2 1 0 2 4 1:100 @ A1  
1:200 @ A3

VER	DESCRIPTION	DATE
01	FUNCTIONAL DESIGN - ISSUED FOR REVIEW	04-05-2021
00	FUNCTIONAL DESIGN - ISSUED FOR REVIEW	30-09-2020

CONSULTANT ENGINEER

**PROCIVIL**  
CONSULTING ENGINEERING

Specialist Civil Engineering Design Consultants

Commitment | Communication | Collaboration

PROCIVIL CONSULTING PTY LTD  
ABN 51 759 386 092  
SUITE 9, 12 MAROONDHAW HWY, RINGWOOD VIC 3134  
PO BOX 164, RINGWOOD VIC 3134  
P: (03) 8644 6834  
E: info@procivil.com.au  
www.procivil.com.au

CIVIL ENGINEERING DESIGN  
DEAN DIMITROS

TECHNICAL PEER REVIEW  
CHRIS PROCTOR

REGISTERED & CHARTERED PROFESSIONAL ENGINEER'S REVIEW  
CHRIS PROCTOR

ORIENTATION

OR AS SHOWN

ORIGINAL SCALE & SHEET SIZE  
AS SHOWN @ A1

HEIGHT DATUM  
AHD

COORDINATE DATUM  
MGA 94 ZONE 55

SURVEY DATE  
29-05-2020

AERIAL IMAGE DATE  
18-12-2019

LOCAL GOVERNMENT AREA  
**SHIRE OF CARDINIA**

CLIENT

CLIENT PROJECT MANAGER / CONTACT  
DANIEL POTTER | CARDINIA SHIRE COUNCIL

**FUNCTIONAL DESIGN**

**ROAD & DRAINAGE RECONSTRUCTION WORKS**

CRICHTON ROAD AND PRINCESS AVENUE, EMERALD

GENERAL LAYOUT PLAN

PROJECT No.  
PC18089

SHEET No.  
05 OF 10

VERSION  
01

DWG No.  
PC18089 - 05 - 01

## LEGEND

- FULL DEPTH PAVEMENT ROAD WIDENING IN ACCORDANCE WITH DETAILS ON SHEET 01
- EXISTING CRUSHED ROCK PAVEMENT OVERLAY IN ACCORDANCE WITH DETAILS ON SHEET 01
- 50mm THICK CLASS 3 CRUSHED ROCK
- ASPHALT VEHICLE CROSSING TO BE CONSTRUCTED IN ACCORDANCE WITH ENGINEERING DESIGN & CONSTRUCTION MANUAL STANDARD DRAWING EDCM 501
- 100mm DEPTH TYPE N SIZE 10mm ASPHALT RAISED PAVEMENT
- CONCRETE VEHICLE CROSSING TO BE CONSTRUCTED IN ACCORDANCE WITH ENGINEERING DESIGN & CONSTRUCTION MANUAL STANDARD DRAWING EDCM 501

- CONCRETE KERB AND CHANNEL IN ACCORDANCE WITH ENGINEERING DESIGN & CONSTRUCTION MANUAL STANDARD DRAWING EDCM 301
- EXISTING DRAINAGE PIPE
- REMOVE/DECOMMISSION EXISTING DRAINAGE PIPE
- NEW DRAINAGE PIT AND PIPE
- TABLE DRAIN INVERT
- DIRECTION OF CHANNEL FLOW
- SHEET FLOW RUNOFF
- PAVEMENT LINE MARKING
- TWO-WAY RAISED REFLECTIVE PAVEMENT MARKERS (RRPMs) TO BE INSTALLED AS SHOWN IN ACCORDANCE WITH VICROADS TRAFFIC ENGINEERING MANUAL VOL 2 CH 19
- PROPOSED PAVEMENT GRADE

- EX W EXISTING WATER
- EX G EXISTING GAS
- EX S EXISTING SEWER
- EX T EXISTING TELECOMMUNICATIONS
- EX E EXISTING UNDERGROUND ELECTRICITY
- E O/H EXISTING UNDERGROUND ELECTRICITY
- EXISTING CONTOUR MAJOR (1.0m)
- EXISTING CONTOUR MINOR (0.20m)
- FILL BATTER EXTENT
- CUT BATTER EXTENT
- TREE TO BE REMOVED
- TREE NUMBER
- BUILD UP AND EVENLY GRADE TOPSOIL FROM BACK OF KERB AND APPLY APPROVED GRASS SEED



**WARNING**  
BEWARE OF UNDERGROUND SERVICES.  
THE LOCATION OF EXISTING UNDERGROUND SERVICES ARE APPROXIMATE ONLY AND THEIR EXACT POSITION SHOULD BE PROVEN ON SITE. NO GUARANTEE IS GIVEN THAT ALL EXISTING SERVICES ARE SHOWN.

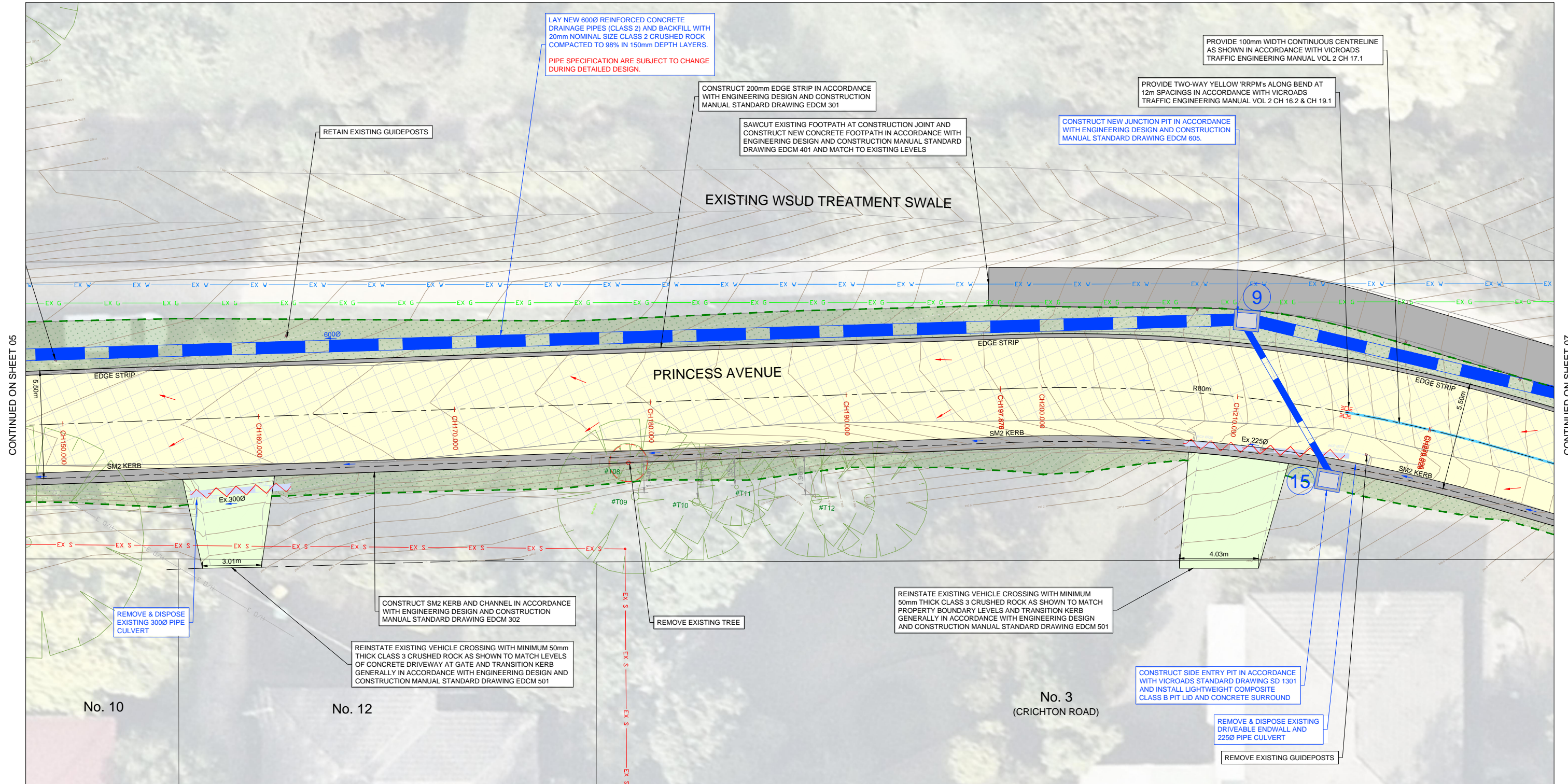

## GENERAL LAYOUT PLAN

2 1 0 2 4 1:100 @ A1  
1:200 @ A3

VER	DESCRIPTION	DATE
01	FUNCTIONAL DESIGN - ISSUED FOR REVIEW	04-05-2021
00	FUNCTIONAL DESIGN - ISSUED FOR REVIEW	30-09-2020

CONSULTANT ENGINEER

**PROCIVIL**  
CONSULTING ENGINEERING

Specialist Civil Engineering Design Consultants

Commitment | Communication | Collaboration

PROCIVIL CONSULTING PTY LTD  
ABN 51 759 386 092  
SUITE 9, 12 MAROONDAH HWY, RINGWOOD VIC 3114  
PO BOX 164, RINGWOOD VIC 3114  
P: (03) 8644 6834  
E: info@procivil.com.au  
www.procivil.com.au

CIVIL ENGINEERING DESIGN  
DEAN DIMITROS

TECHNICAL PEER REVIEW  
CHRIS PROCTOR

REGISTERED & CHARTERED PROFESSIONAL ENGINEER'S REVIEW  
CHRIS PROCTOR

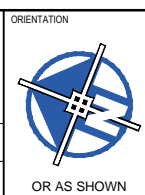

ORIGINAL SCALE & SHEET SIZE AS SHOWN @ A1
HEIGHT DATUM AHD
COORDINATE DATUM MGA 94 ZONE 55
SURVEY DATE 29-05-2020
AERIAL IMAGE DATE 18-12-2019

LOCAL GOVERNMENT AREA  
**SHIRE OF CARDINIA**

CLIENT

**Cardinia**

CLIENT PROJECT MANAGER / CONTACT  
DANIEL POTTER | CARDINIA SHIRE COUNCIL

**FUNCTIONAL DESIGN**

**ROAD & DRAINAGE RECONSTRUCTION WORKS**

**CRICHTON ROAD AND PRINCESS AVENUE, EMERALD**

GENERAL LAYOUT PLAN

PROJECT No. PC18089
SHEET No. 06 OF 10
VERSION 01
DWG No. PC18089 - 06 - 01

## LEGEND

- FULL DEPTH PAVEMENT ROAD WIDENING IN ACCORDANCE WITH DETAILS ON SHEET 01
- EXISTING CRUSHED ROCK PAVEMENT OVERLAY IN ACCORDANCE WITH DETAILS ON SHEET 01
- 50mm THICK CLASS 3 CRUSHED ROCK
- ASPHALT VEHICLE CROSSING TO BE CONSTRUCTED IN ACCORDANCE WITH ENGINEERING DESIGN & CONSTRUCTION MANUAL STANDARD DRAWING EDCM 501
- 100mm DEPTH TYPE N SIZE 10mm ASPHALT RAISED PAVEMENT
- CONCRETE VEHICLE CROSSING TO BE CONSTRUCTED IN ACCORDANCE WITH ENGINEERING DESIGN & CONSTRUCTION MANUAL STANDARD DRAWING EDCM 501

- CONCRETE KERB AND CHANNEL IN ACCORDANCE WITH ENGINEERING DESIGN & CONSTRUCTION MANUAL STANDARD DRAWING EDCM 301
- EXISTING DRAINAGE PIPE
- REMOVE/DECOMMISSION EXISTING DRAINAGE PIPE
- NEW DRAINAGE PIT AND PIPE
- TABLE DRAIN INVERT
- DIRECTION OF CHANNEL FLOW
- SHEET FLOW RUNOFF
- PAVEMENT LINE MARKING
- TWO-WAY RAISED REFLECTIVE PAVEMENT MARKERS (RRPMs) TO BE INSTALLED AS SHOWN IN ACCORDANCE WITH VICROADS TRAFFIC ENGINEERING MANUAL VOL 2 CH 19
- PROPOSED PAVEMENT GRADE

- EX W EXISTING WATER
- EX G EXISTING GAS
- EX S EXISTING SEWER
- EX T EXISTING TELECOMMUNICATIONS
- EX E EXISTING UNDERGROUND ELECTRICITY
- EX OH EXISTING UNDERGROUND ELECTRICITY
- EXISTING CONTOUR MAJOR (1.0m)
- EXISTING CONTOUR MINOR (0.20m)
- FILL BATTER EXTENT
- CUT BATTER EXTENT
- TREE TO BE REMOVED
- TREE NUMBER
- BUILD UP AND EVENLY GRADE TOPSOIL FROM BACK OF KERB AND APPLY APPROVED GRASS SEED



**WARNING**  
BEWARE OF UNDERGROUND SERVICES  
THE LOCATION OF EXISTING UNDERGROUND SERVICES ARE APPROXIMATE ONLY AND THEIR EXACT POSITION SHOULD BE PROVEN ON SITE. NO GUARANTEE IS GIVEN THAT ALL EXISTING SERVICES ARE SHOWN.

CONTINUED ON SHEET 06

CONTINUED ON SHEET 08

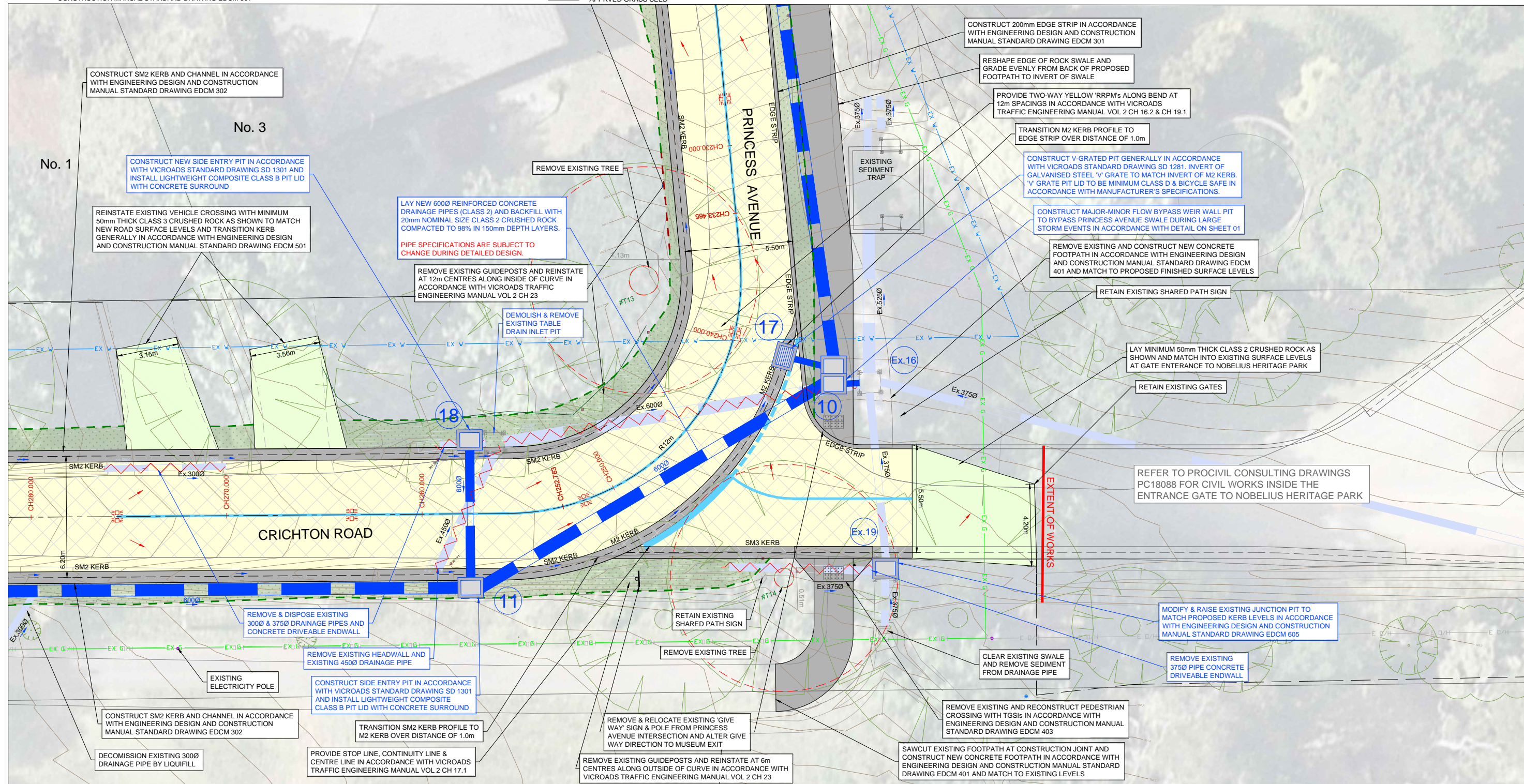

## GENERAL LAYOUT PLAN

2 1 0 2 4 1:100 @ A1  
1:200 @ A3

01	FUNCTIONAL DESIGN - ISSUED FOR REVIEW	04-05-2021
00	FUNCTIONAL DESIGN - ISSUED FOR REVIEW	30-09-2020
VER	DESCRIPTION	DATE

CONSULTANT ENGINEER

**PROCIVIL**  
CONSULTING ENGINEERING

Specialist Civil Engineering Design Consultants

Commitment | Communication | Collaboration

PROCIVIL CONSULTING PTY LTD  
ABN 51 759 386 082  
SUITE 9, 12 MAROONDHA HWY, RINGWOOD VIC 31134  
PO BOX 164, RINGWOOD VIC 31134  
P: (03) 8644 6834  
E: info@procivil.com.au  
www.procivil.com.au

CIVIL ENGINEERING DESIGN  
DEAN DIMITROS

TECHNICAL PEER REVIEW  
CHRIS PROCTOR

REGISTERED & CHARTERED PROFESSIONAL ENGINEER'S REVIEW  
CHRIS PROCTOR

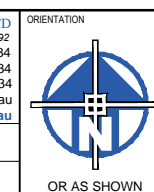

ORIENTATION

ORIGINAL SCALE & SHEET SIZE  
AS SHOWN @ A1

HEIGHT DATUM  
AHD

COORDINATE DATUM  
MGA 94 ZONE 55

SURVEY DATE  
29-05-2020

AERIAL IMAGE DATE  
18-12-2019

LOCAL GOVERNMENT AREA  
**SHIRE OF CARDINIA**

CLIENT

**Cardinia**

CLIENT PROJECT MANAGER / CONTACT  
DANIEL POTTER | CARDINIA SHIRE COUNCIL

**FUNCTIONAL DESIGN**

**ROAD & DRAINAGE RECONSTRUCTION WORKS**  
CRICHTON ROAD AND PRINCESS AVENUE, EMERALD

GENERAL LAYOUT PLAN

PROJECT No.  
PC18089

SHEET No.  
07 OF 10

VERSION  
01

DWG No.  
PC18089 - 07 - 01

## LEGEND

- FULL DEPTH PAVEMENT ROAD WIDENING IN ACCORDANCE WITH DETAILS ON SHEET 01
- EXISTING CRUSHED ROCK PAVEMENT OVERLAY IN ACCORDANCE WITH DETAILS ON SHEET 01
- 50mm THICK CLASS 3 CRUSHED ROCK
- ASPHALT VEHICLE CROSSING TO BE CONSTRUCTED IN ACCORDANCE WITH ENGINEERING DESIGN & CONSTRUCTION MANUAL STANDARD DRAWING EDCM 501
- 100mm DEPTH TYPE N SIZE 10mm ASPHALT RAISED PAVEMENT
- CONCRETE VEHICLE CROSSING TO BE CONSTRUCTED IN ACCORDANCE WITH ENGINEERING DESIGN & CONSTRUCTION MANUAL STANDARD DRAWING EDCM 501

- CONCRETE KERB AND CHANNEL IN ACCORDANCE WITH ENGINEERING DESIGN & CONSTRUCTION MANUAL STANDARD DRAWING EDCM 301
- EXISTING DRAINAGE PIPE
- REMOVE/DECOMMISSION EXISTING DRAINAGE PIPE
- NEW DRAINAGE PIT AND PIPE
- TABLE DRAIN INVERT
- DIRECTION OF CHANNEL FLOW
- SHEET FLOW RUNOFF
- PAVEMENT LINE MARKING
- TWO-WAY RAISED REFLECTIVE PAVEMENT MARKERS (RRPMs) TO BE INSTALLED AS SHOWN IN ACCORDANCE WITH VICROADS TRAFFIC ENGINEERING MANUAL VOL 2 CH 19
- PROPOSED PAVEMENT GRADE

- EX W EXISTING WATER
- EX G EXISTING GAS
- EX S EXISTING SEWER
- EX T EXISTING TELECOMMUNICATIONS
- EX E EXISTING UNDERGROUND ELECTRICITY
- E O/H EXISTING UNDERGROUND ELECTRICITY
- EXISTING CONTOUR MAJOR (1.0m)
- EXISTING CONTOUR MINOR (0.20m)
- FILL BATTER EXTENT
- CUT BATTER EXTENT
- TREE TO BE REMOVED
- TREE NUMBER
- BUILD UP AND EVENLY GRADE TOPSOIL FROM BACK OF KERB AND APPLY APPROVED GRASS SEED



**WARNING**  
BEWARE OF UNDERGROUND SERVICES.  
THE LOCATION OF EXISTING UNDERGROUND SERVICES ARE APPROXIMATE ONLY AND THEIR EXACT POSITION SHOULD BE PROVEN ON SITE. NO GUARANTEE IS GIVEN THAT ALL EXISTING SERVICES ARE SHOWN.

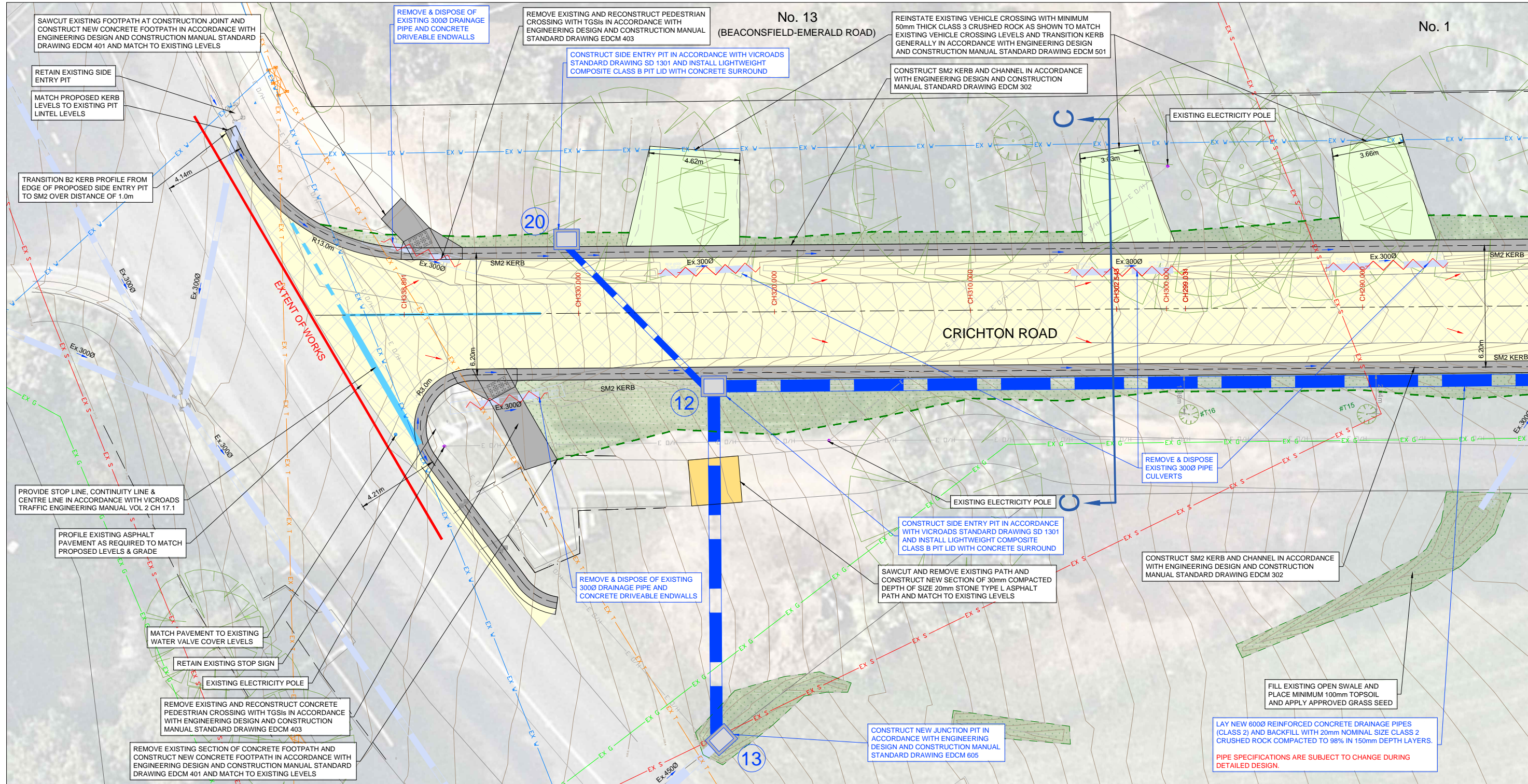

GENERAL LAYOUT PLAN

2 1 0 2 4 1:100 @ A1  
1:200 @ A3

VER	DESCRIPTION	DATE
01	FUNCTIONAL DESIGN - ISSUED FOR REVIEW	04-05-2021
00	FUNCTIONAL DESIGN - ISSUED FOR REVIEW	30-09-2020

CONSULTANT ENGINEER

**PROCVIL**  
CONSULTING ENGINEERING

Specialist Civil Engineering Design Consultants

Commitment | Communication | Collaboration

PROCVIL CONSULTING PTY LTD  
ABN 51 759 386 092  
SUITE 9, 12 MAROONDAH HWY, RINGWOOD VIC 3134  
PO BOX 164, RINGWOOD VIC 3134  
P: (03) 8644 6834  
E: info@procvil.com.au  
www.procvil.com.au

CIVIL ENGINEERING DESIGN  
DEAN DIMITROS

TECHNICAL PEER REVIEW  
CHRIS PROCTOR

REGISTERED & CHARTERED PROFESSIONAL ENGINEER'S REVIEW  
CHRIS PROCTOR

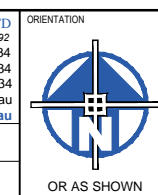

ORIGINAL SCALE & SHEET SIZE  
AS SHOWN @ A1

HEIGHT DATUM  
AHD

COORDINATE DATUM  
MGA 94 ZONE 55

SURVEY DATE  
29-05-2020

AERIAL IMAGE DATE  
18-12-2019

LOCAL GOVERNMENT AREA  
**SHIRE OF CARDINIA**

CLIENT

**Cardinia**

CLIENT PROJECT MANAGER / CONTACT  
DANIEL POTTER | CARDINIA SHIRE COUNCIL

**FUNCTIONAL DESIGN**

**ROAD & DRAINAGE RECONSTRUCTION WORKS**

**CRICHTON ROAD AND PRINCESS AVENUE, EMERALD**

GENERAL LAYOUT PLAN

PROJECT No.	PC18089
SHEET No.	08 OF 10
VERSION	01
DWG No.	PC18089-08-01

CONTINUED ON SHEET 07



**WARNING**  
BEWARE OF UNDERGROUND SERVICES.  
THE LOCATION OF EXISTING UNDERGROUND SERVICES ARE APPROXIMATE  
ONLY AND THEIR EXACT POSITION SHOULD BE PROVEN ON SITE. NO  
GUARANTEE IS GIVEN THAT ALL EXISTING SERVICES ARE SHOWN.

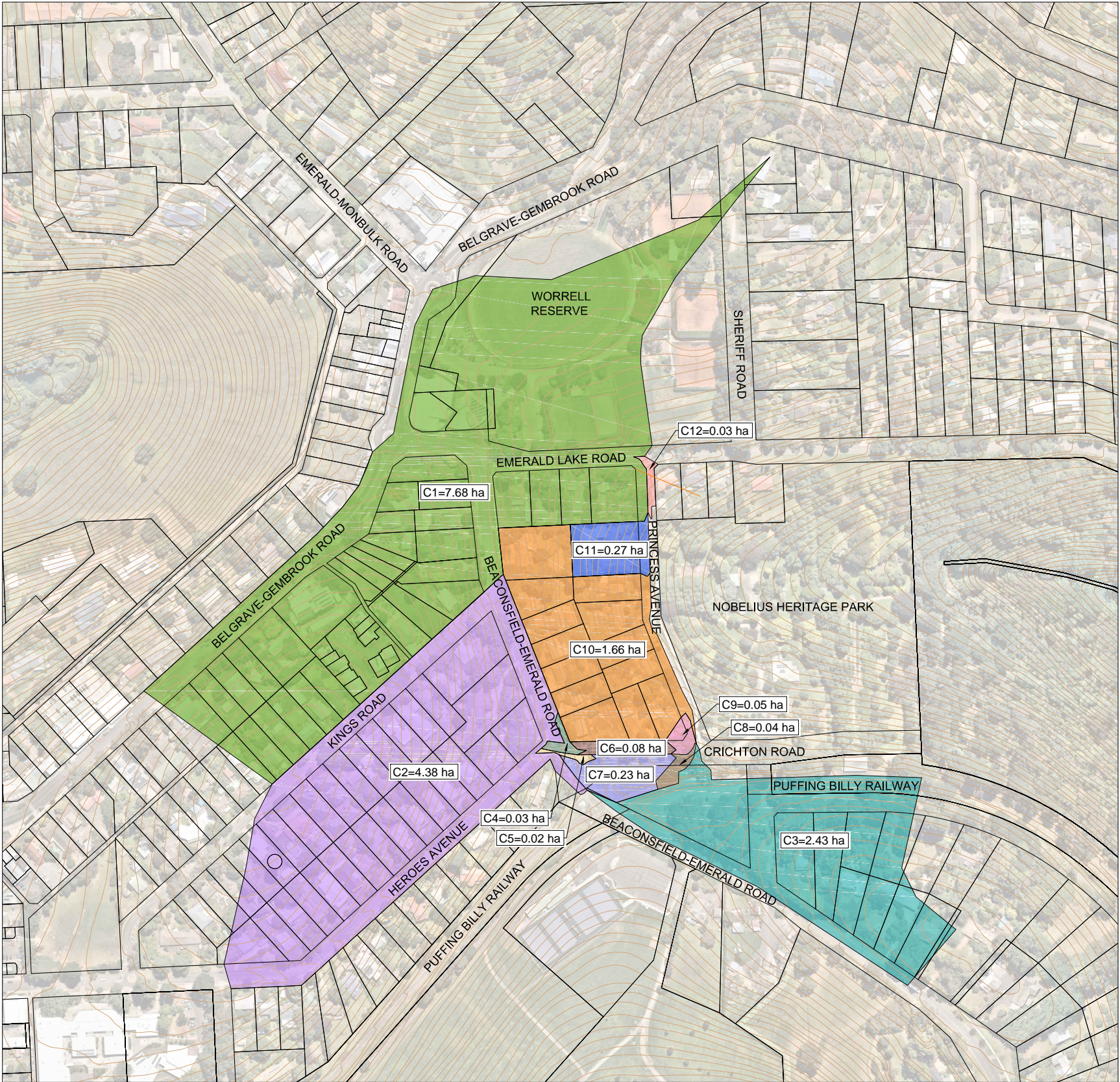

DRAINAGE CATCHMENT ANALYSIS PLAN



01	FUNCTIONAL DESIGN - ISSUED FOR REVIEW	04-05-2021
00	FUNCTIONAL DESIGN - ISSUED FOR REVIEW	30-09-2020
VER	DESCRIPTION	DATE

CONSULTANT ENGINEER

**PROCIVIL**  
CONSULTING ENGINEERING

Specialist Civil Engineering Design Consultants

Commitment | Communication | Collaboration

PROCIVIL CONSULTING PTY LTD

ABN 51 759 386 082

SUITE 9, 12 MAROONDAH HWY, RINGWOOD VIC 3134

PO BOX 164, RINGWOOD VIC 3134

P: (03) 8644 6834

E: info@procivil.com.au

www.procivil.com.au

CIVIL ENGINEERING DESIGN

DEAN DIMITROS

REGISTERED & CHARTERED PROFESSIONAL ENGINEER'S REVIEW

CHRIS PROCTOR

TECHNICAL PEER REVIEW

CHRIS PROCTOR

ORIENTATION

OR AS SHOWN

ORIGINAL SCALE & SHEET SIZE

AS SHOWN @ A1

HEIGHT DATUM

AHD

COORDINATE DATUM

MGA 94 ZONE 55

SURVEY DATE

29-05-2020

AERIAL IMAGE DATE

18-12-2019

LOCAL GOVERNMENT AREA

SHIRE OF CARDINIA

CLIENT

CLIENT PROJECT MANAGER / CONTACT

DANIEL POTTER | CARDINIA SHIRE COUNCIL

FUNCTIONAL DESIGN

ROAD & DRAINAGE RECONSTRUCTION WORKS

CRICHTON ROAD AND PRINCESS AVENUE, EMERALD

DRAINAGE CATCHMENT ANALYSIS PLAN

PROJECT No.

PC18089

SHEET No.

09 OF 10

VERSION

01

DWG No.

PC18089 - 09 - 01

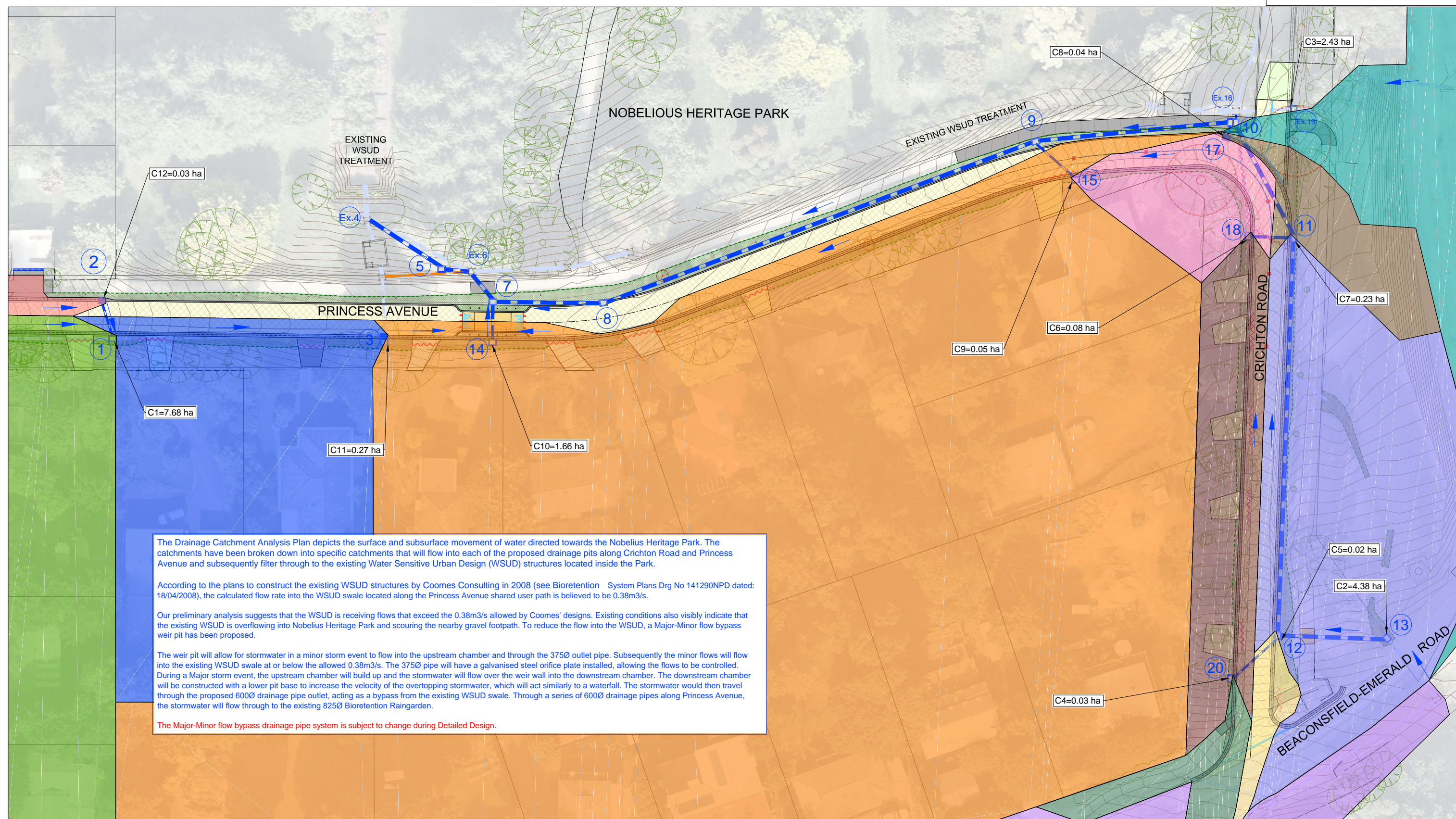
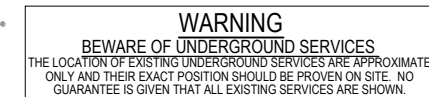

6 3 0 6 12

1:300 @ A1

1:600 @ A2

[illegible]