



# WORRELL RESERVE SKATEPARK FINAL CONCEPT



12 APRIL 2023



# Funded Skatepark & Youth Plaza Design

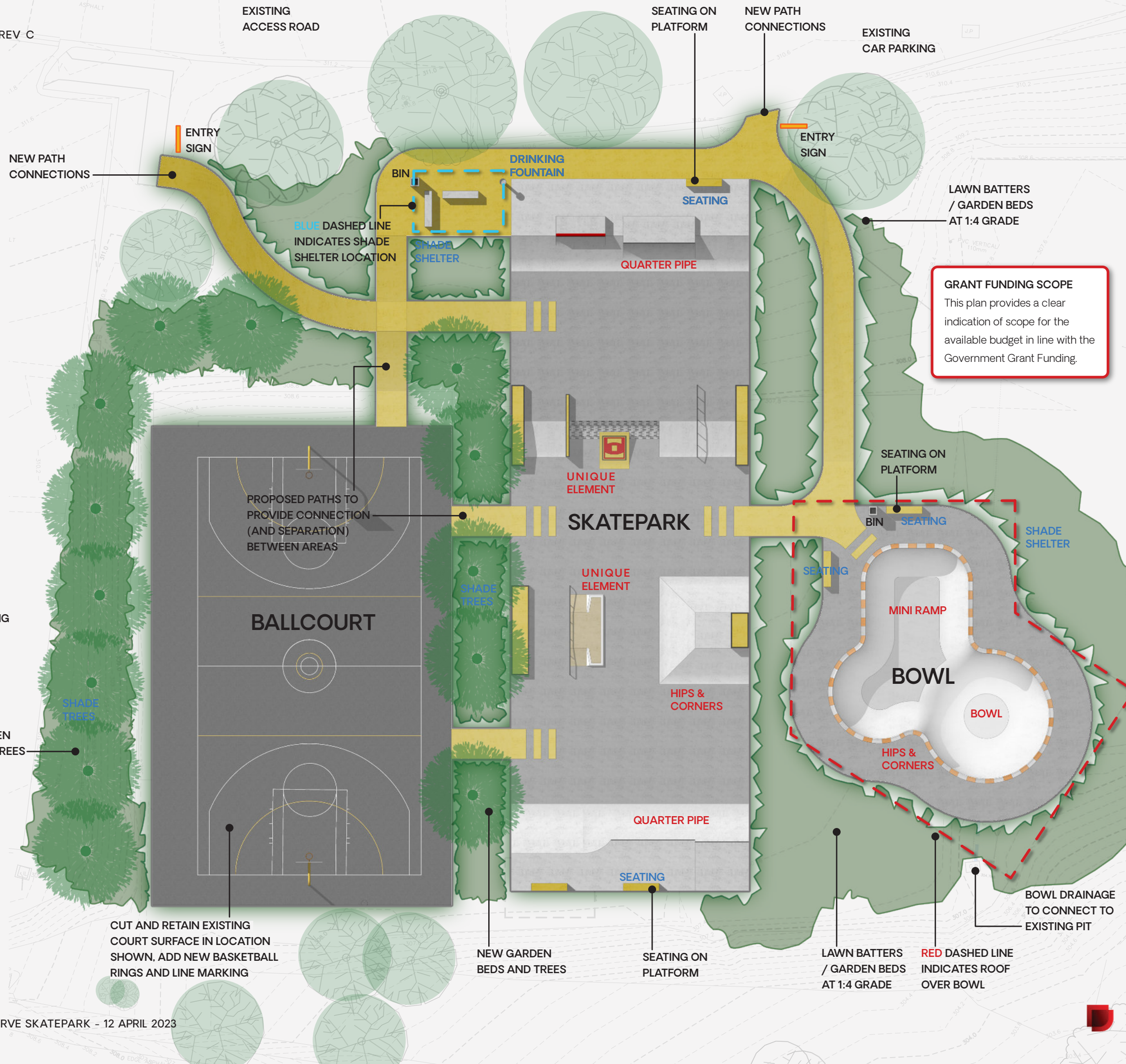

**TOP 5**  
HIPS & CORNERS  
**BOWL**  
MINI RAMP  
QUARTER PIPE  
UNIQUE ELEMENT

(RED TEXT INDICATES TOP 5 SKATE ELEMENTS)

**DESIGN SUMMARY**  
The new skatepark has been designed to capture the Top 5 Skate Elements that were chosen during the community consultation process and the overall design also takes into consideration the Top 5 Plaza Elements to complete the list.

Alongside these Top 5's, the available budget has allowed for further inclusions to make sure beginner, intermediate and advanced riders are catered for with a wide variety of heights, angles and elements.

The whole space has been designed to work with the existing landform, create clear and open entry points and importantly, provide elements that do not exist in the surrounding skateparks to further enhance the diversity of terrain in the broader area.

**TOP 5**  
**SEATING**  
SHADE SHELTERS  
**LIGHTS**  
DRINKING FOUNTAIN  
**SHADE TREES**

(BLUE TEXT INDICATES TOP 5 PLAZA ELEMENTS)



Skatepark Concept Plan



**SKILL RANKING GUIDE**

Beginner ●●●●●

Intermediate ■ ■ ■ ■ ■

Advanced ◆ ◆ ◆ ◆ ◆

**ELEMENT INCLUSION GUIDE**

BOWL	STREET	PLAZA	VERT
TRANSITION	BANK	SPINE	HIP
EURO-GAP	RAIL	STAIRS	HUBBA
LEDGE	MANUAL PAD	KERB	MOGUL
PYRAMID	JUMP-BOX	PUMP TRACK	

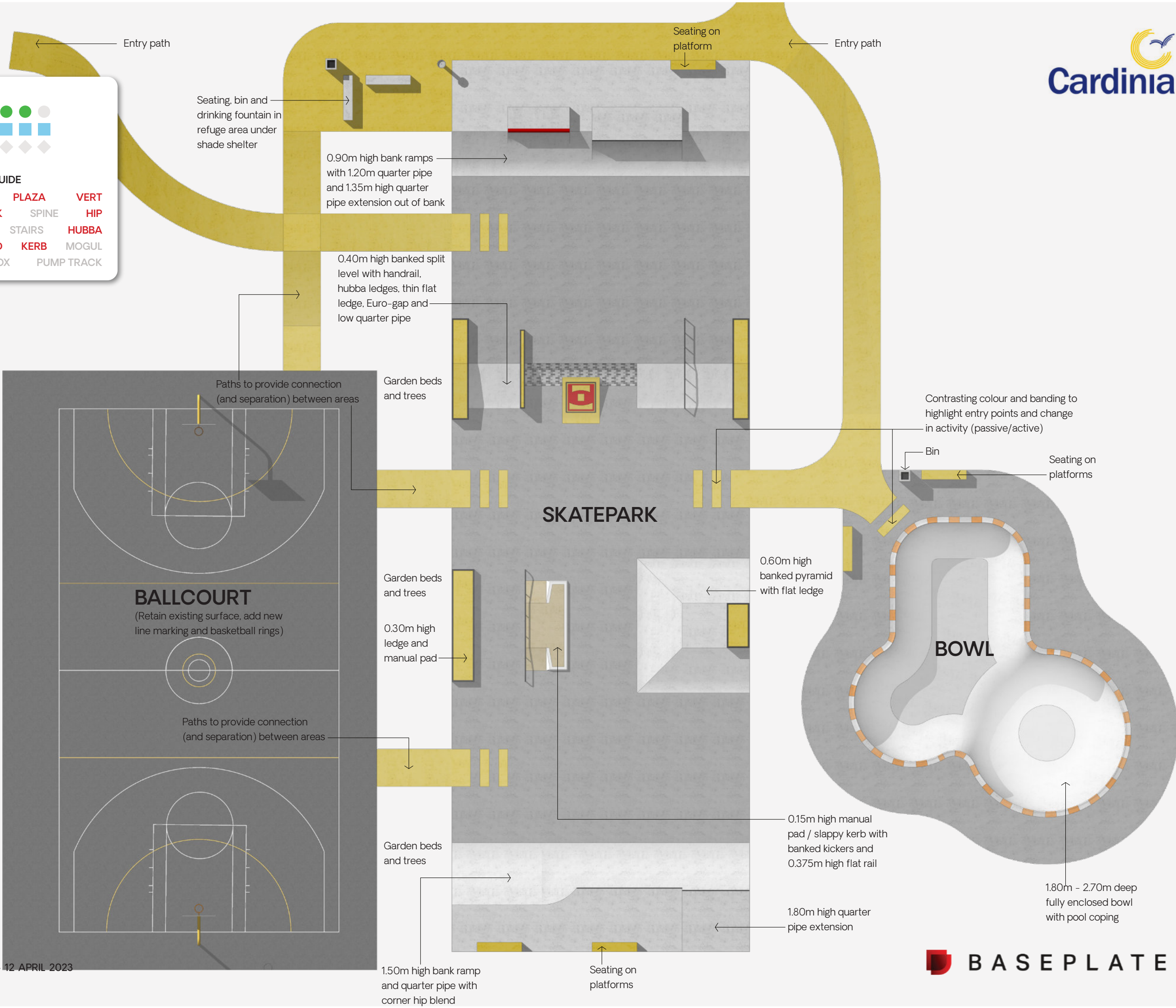

Scan QR code to open the interactive 3D model via Kubity app or web.

Perspective View 1

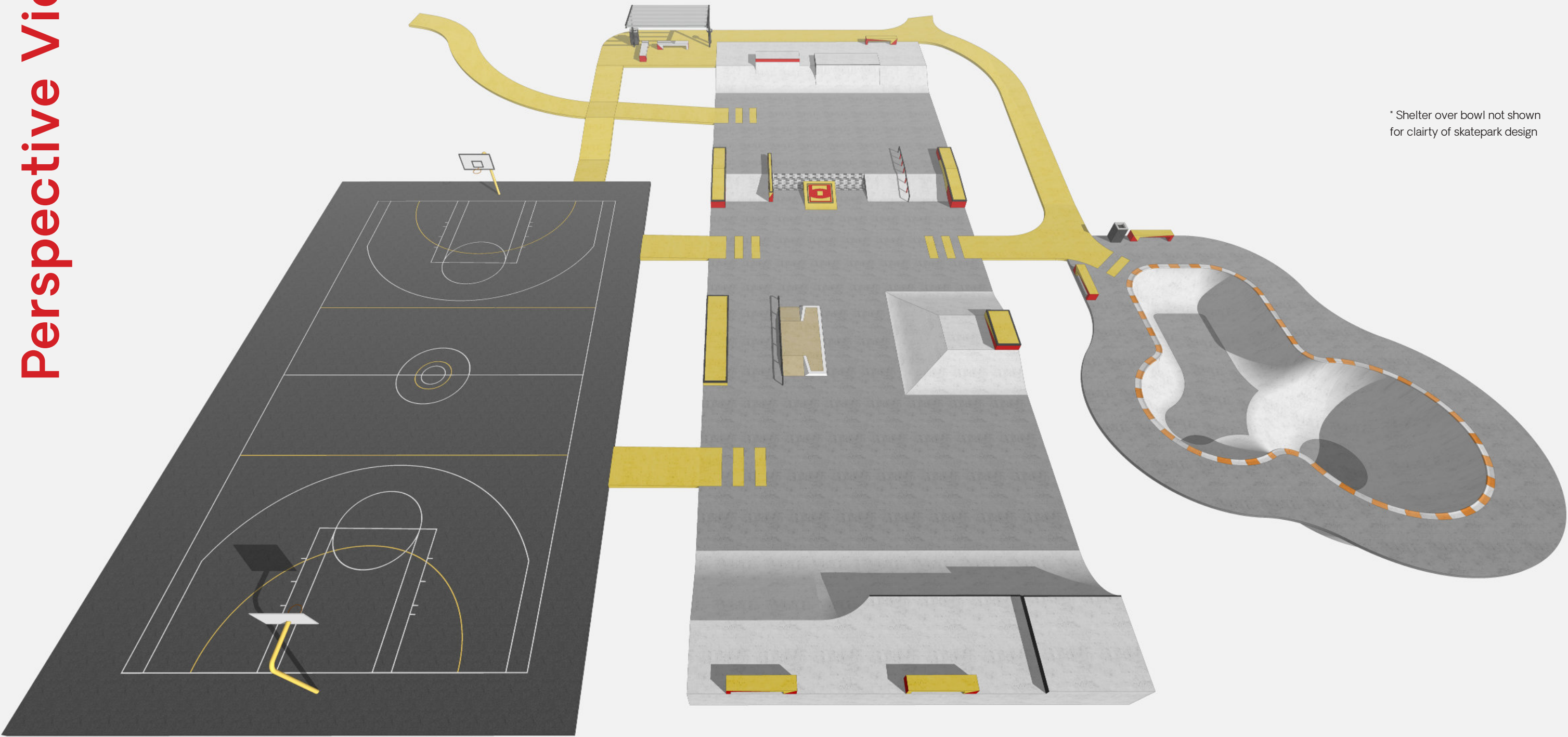

\* Shelter over bowl not shown  
for clarity of skatepark design



Scan QR code to open  
the interactive 3D model  
via Kubby app or web.



Perspective View 2

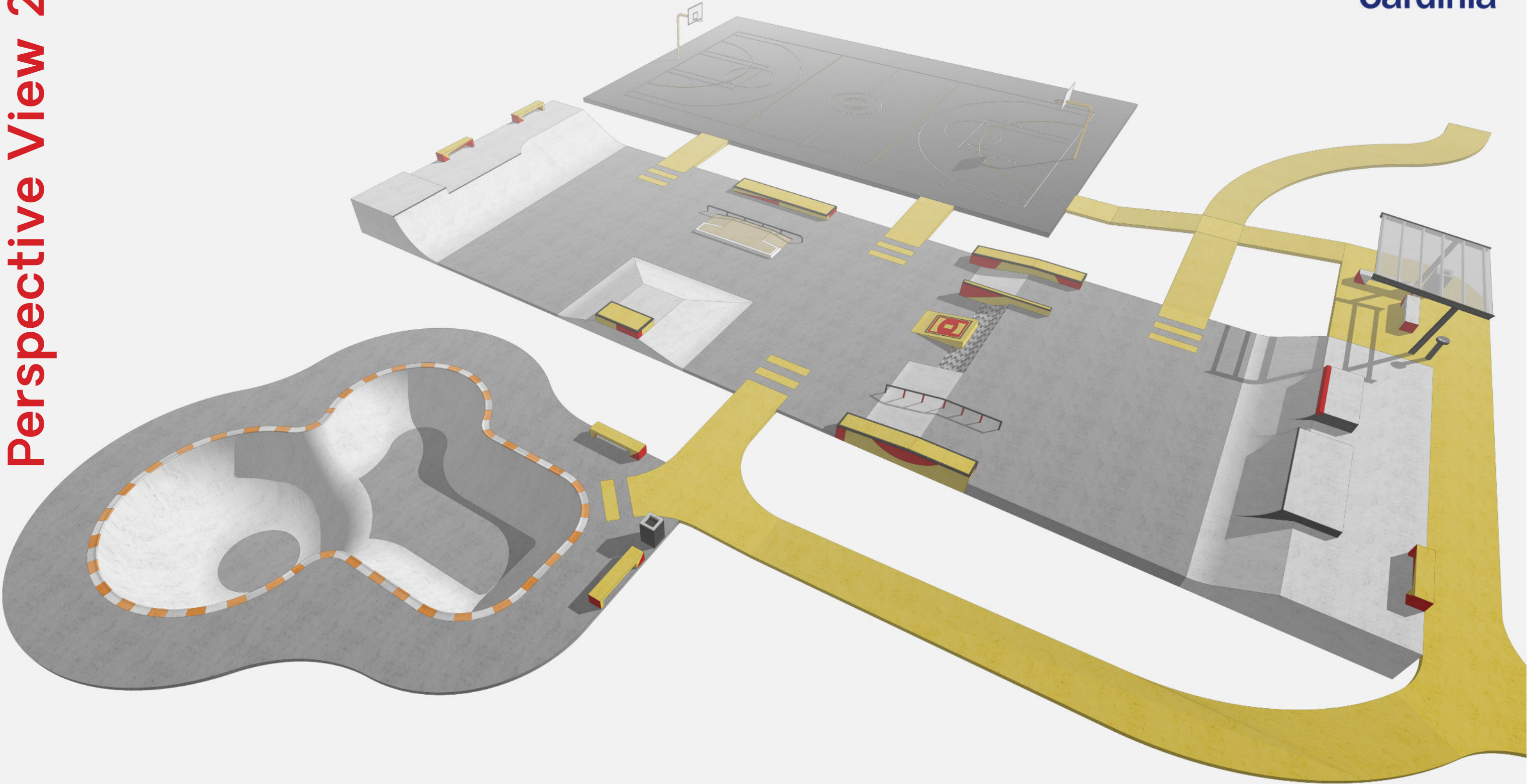

\* Shelter over bowl not shown  
for clarity of skatepark design



Scan QR code to open  
the interactive 3D model  
via Kubity app or web.



Perspective View 3

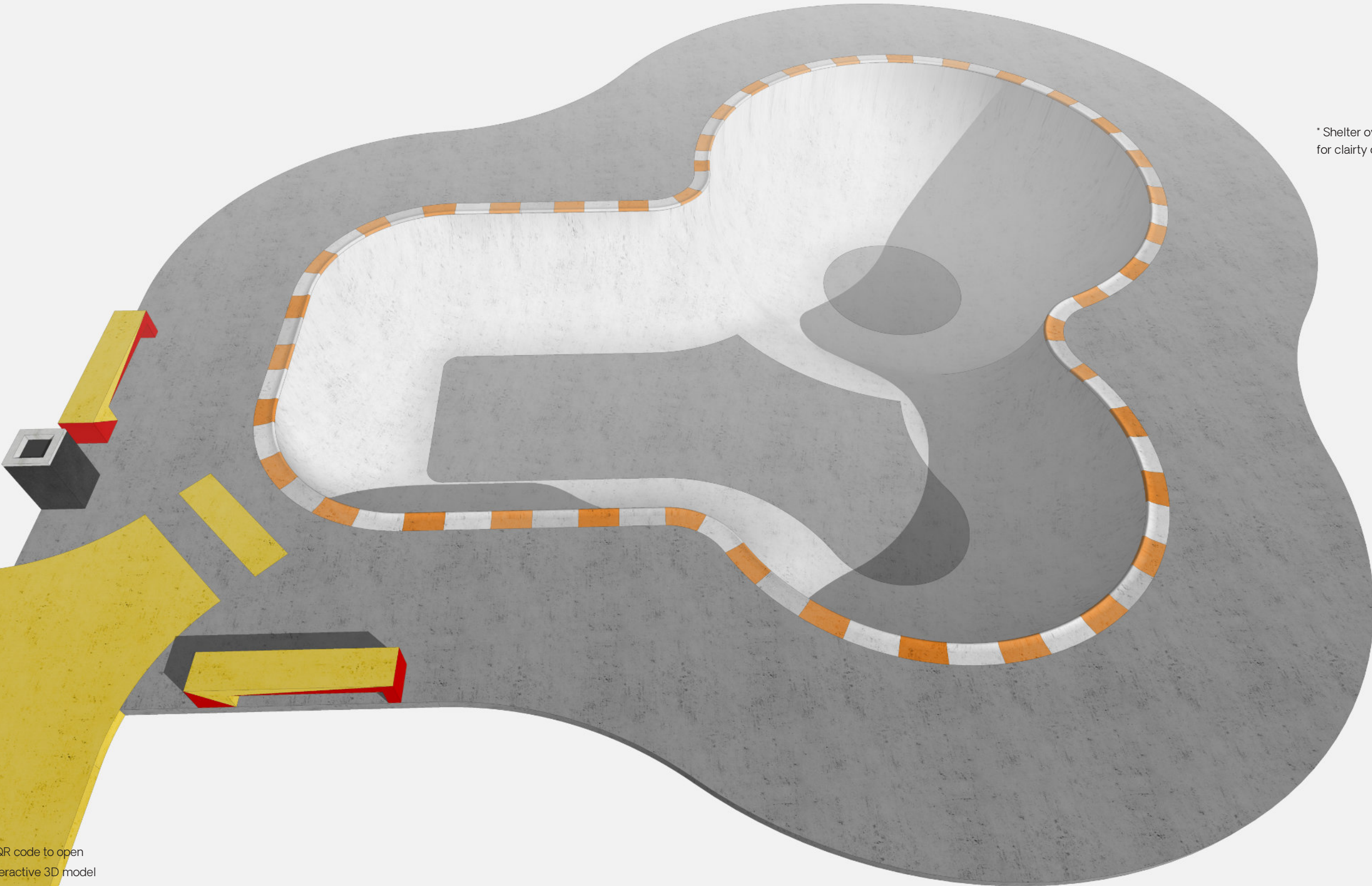

\* Shelter over bowl not shown for clarity of skatepark design



Scan QR code to open the interactive 3D model via Kubity app or web.



# Perspective View 4

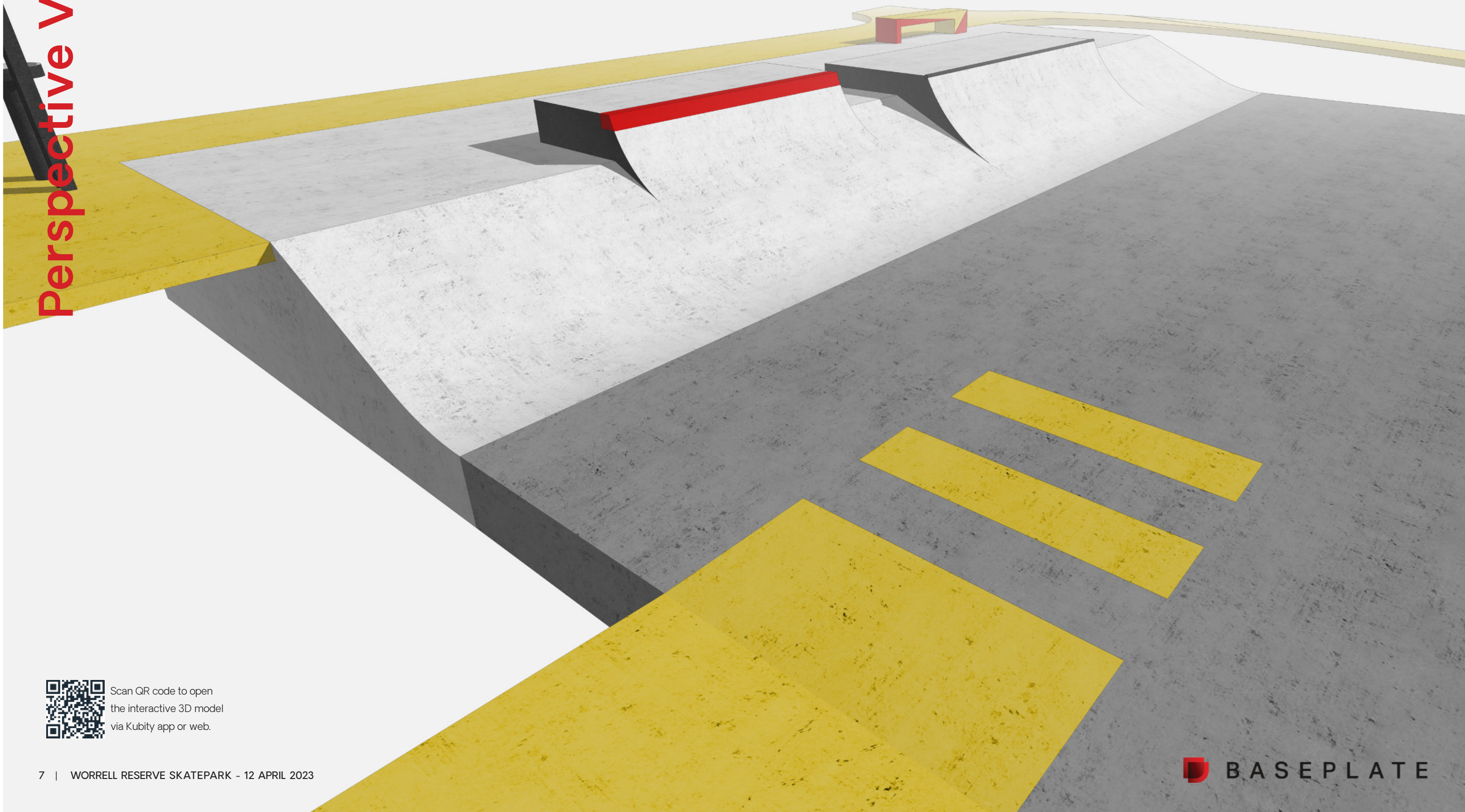

Scan QR code to open  
the interactive 3D model  
via Kubity app or web.



Perspective View 5

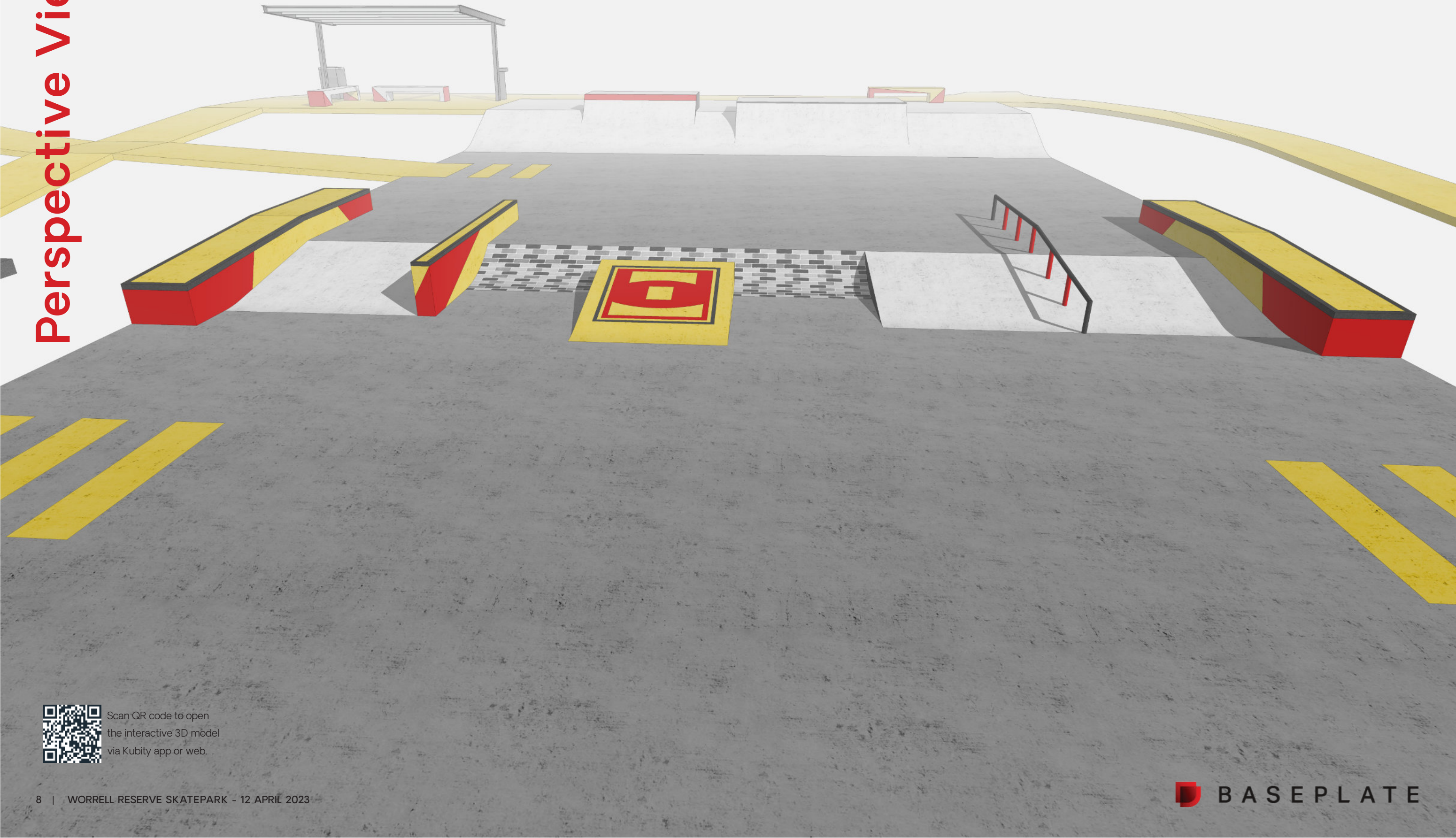

Scan QR code to open  
the interactive 3D model  
via Kubity app or web.



Perspective View 6

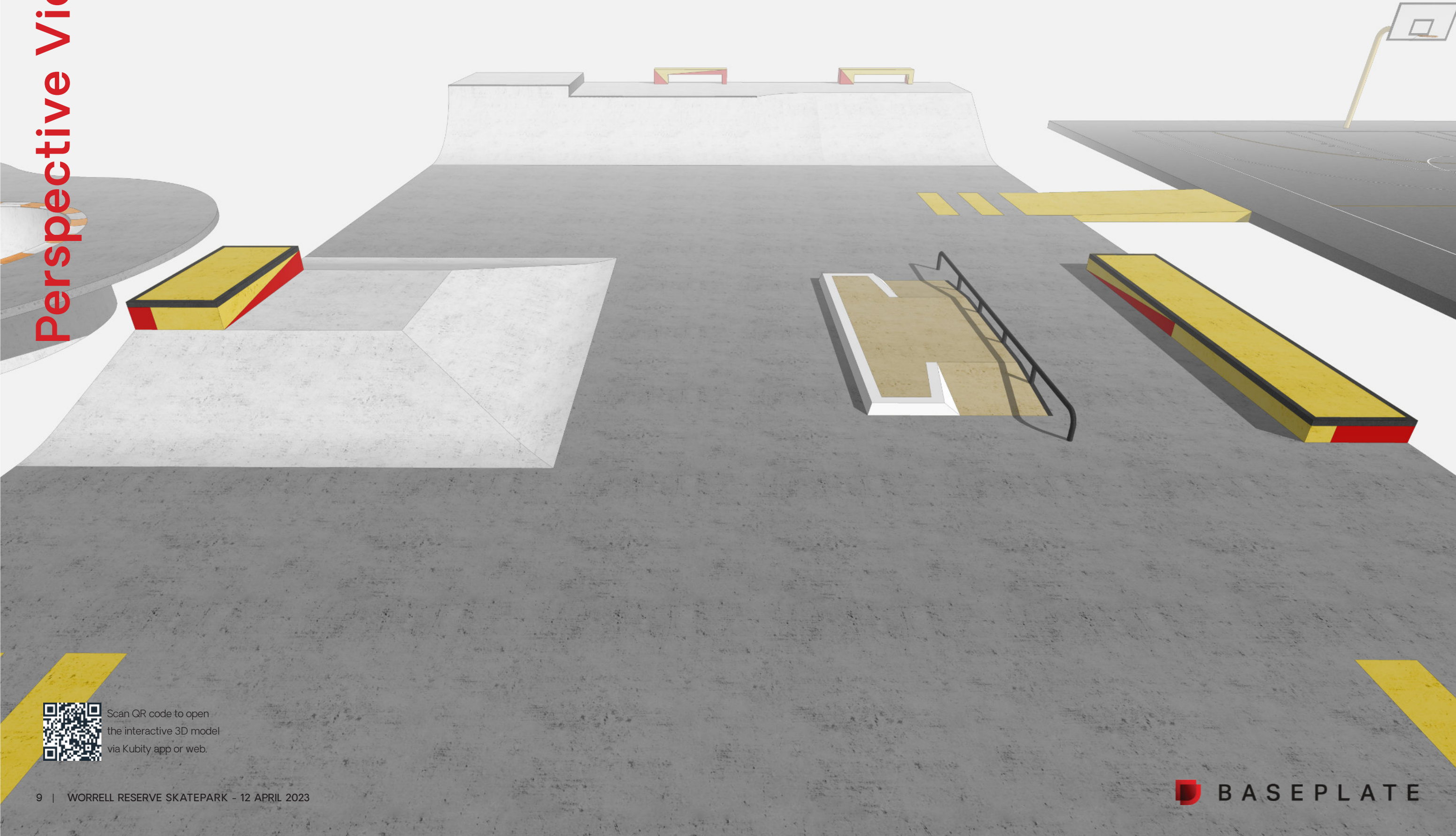

Scan QR code to open  
the interactive 3D model  
via Kubity app or web.



Perspective View 7

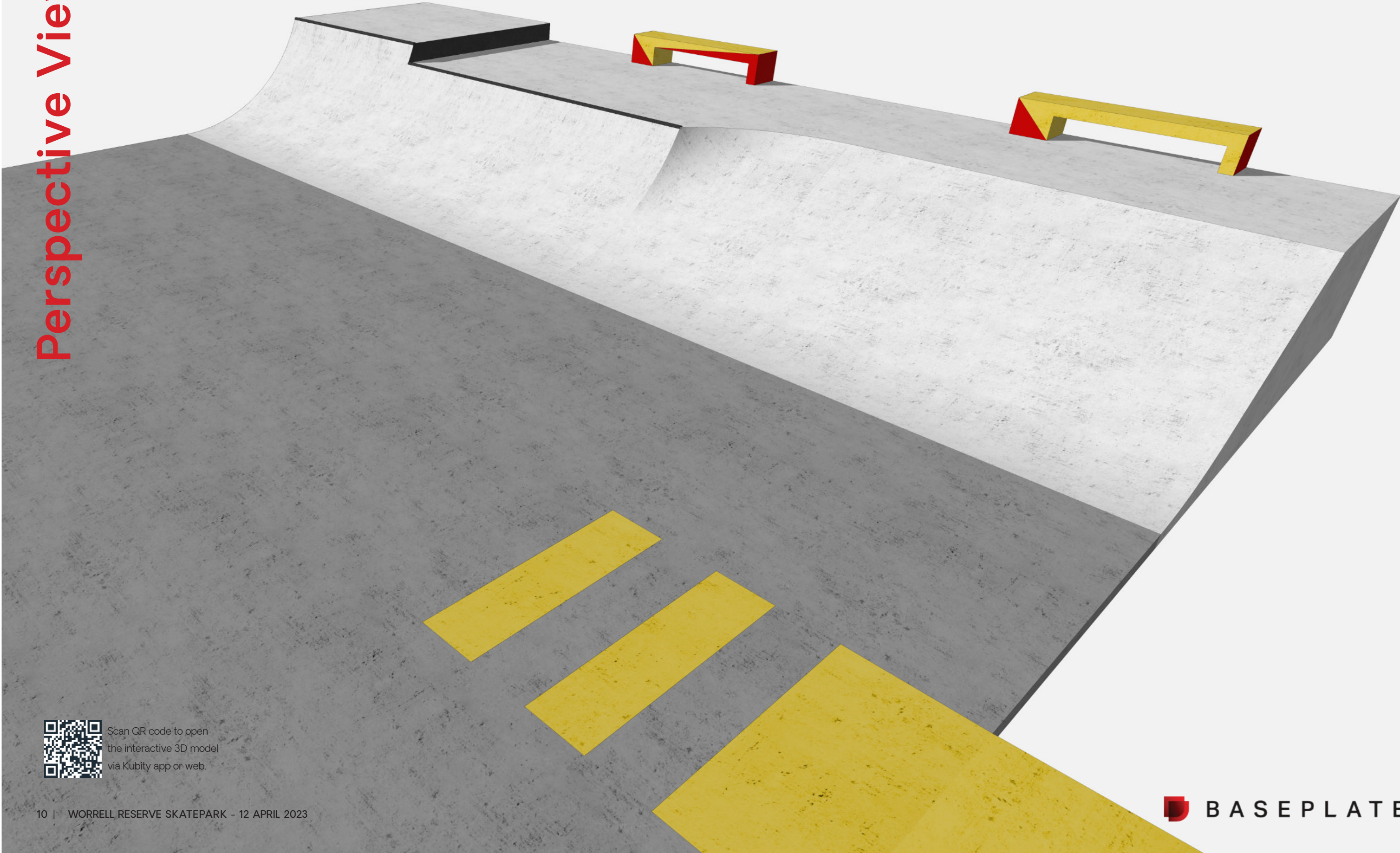

Scan QR code to open  
the interactive 3D model  
via Kubity app or web.



# Future Concept Design Youth Plaza (Stage 2)



**TOP 5**

HIPS & CORNERS  
**BOWL**  
MINI RAMP  
QUARTER PIPE  
UNIQUE ELEMENT

(RED TEXT INDICATES TOP 5 SKATE ELEMENTS)

**DESIGN SUMMARY**

The new skatepark has been designed to capture the Top 5 Skate Elements that were chosen during the community consultation process and the overall design also takes into consideration the Top 5 Plaza Elements to complete the list.

Alongside these Top 5's, the available budget has allowed for further inclusions to make sure beginner, intermediate and advanced riders are catered for with a wide variety of heights, angles and elements.

The whole space has been designed to work with the existing landform, create clear and open entry points and importantly, provide elements that do not exist in the surrounding skateparks to further enhance the diversity of terrain in the broader area.

**TOP 5**

SEATING  
SHADE SHELTERS  
LIGHTS  
DRINKING FOUNTAIN  
SHADE TREES

(BLUE TEXT INDICATES TOP 5 PLAZA ELEMENTS)



Skatepark Concept Plan (Stage 2)

**SKILL RANKING GUIDE**

Beginner ●●●●●

Intermediate ■ ■ ■ ■ ■

Advanced ◆ ◆ ◆ ◆ ◆

**ELEMENT INCLUSION GUIDE**

BOWL	STREET	PLAZA	VERT
TRANSITION	BANK	SPINE	HIP
EURO-GAP	RAIL	STAIRS	HUBBA
LEDGE	MANUAL PAD	KERB	MOGUL
PYRAMID	JUMP-BOX	PUMP TRACK	

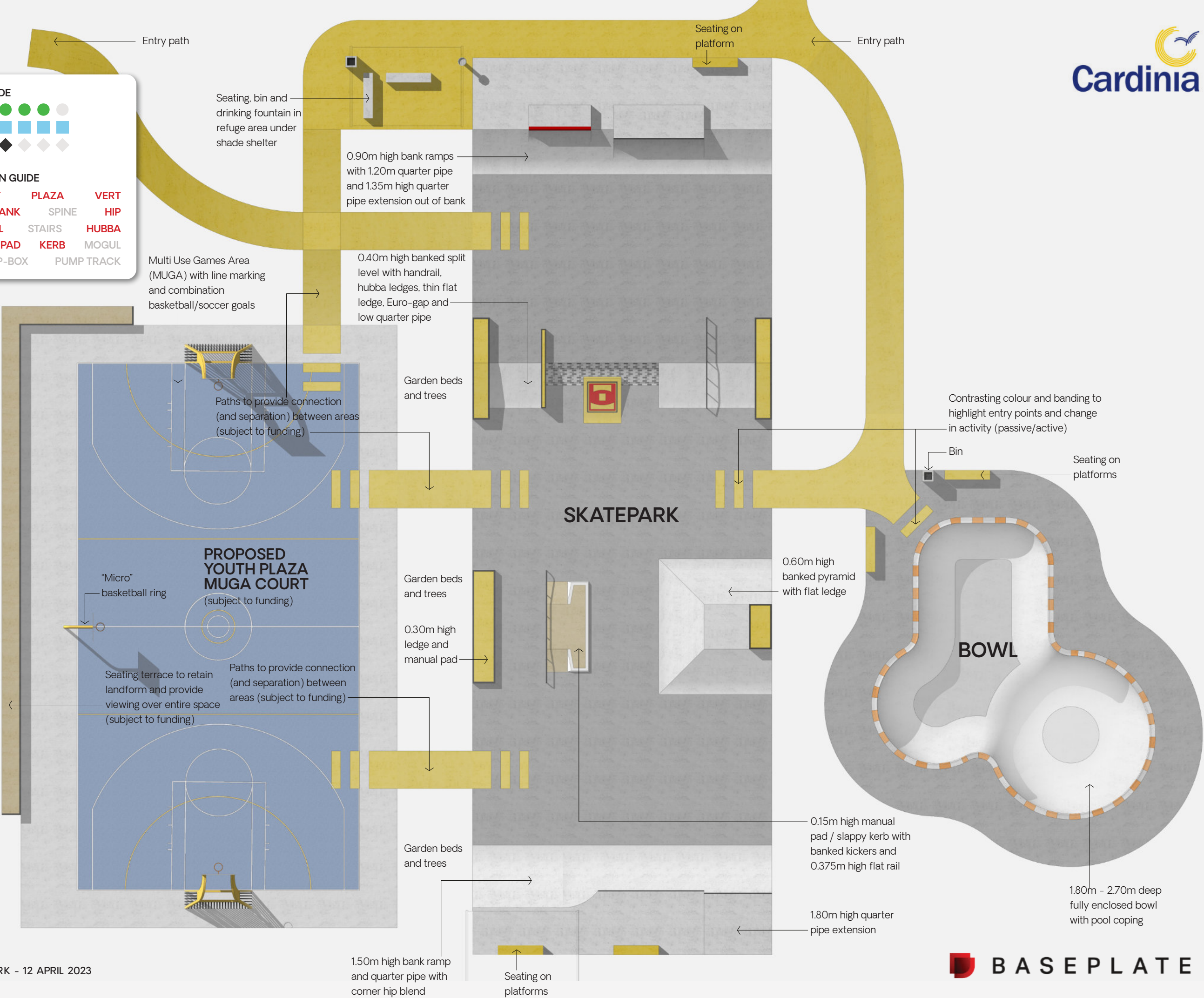



Perspective View 1 (Stage 2)

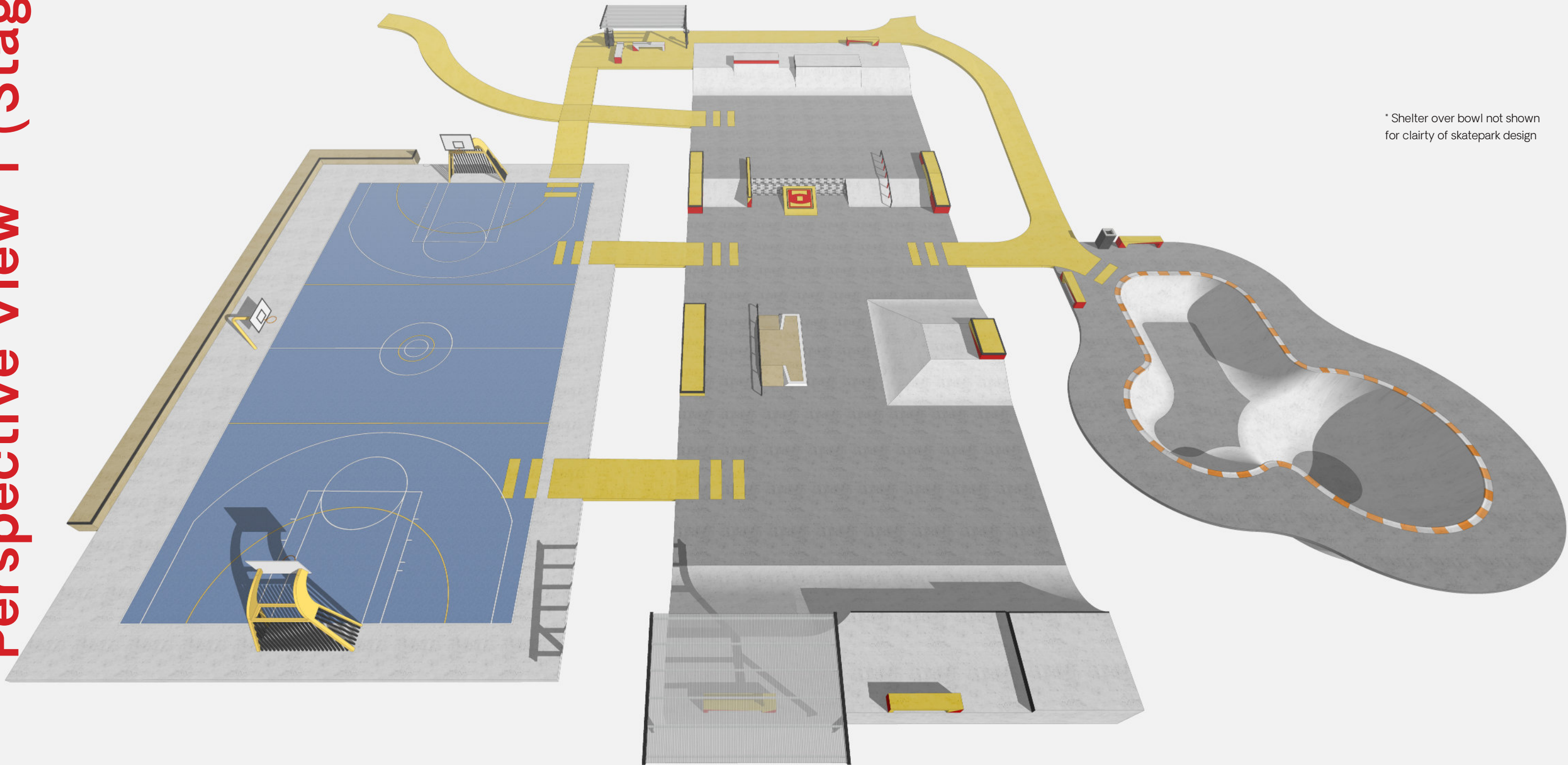

\* Shelter over bowl not shown  
for clarity of skatepark design



